

SHED PACK

Step 1: Choose your shed type.

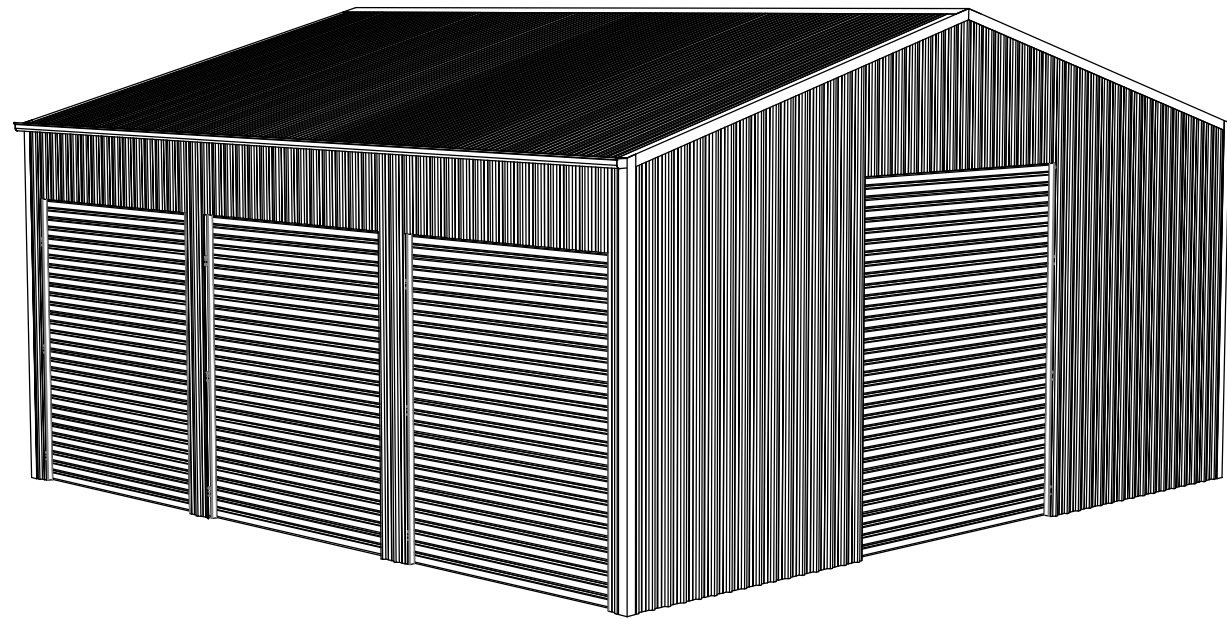

Industrial Shed

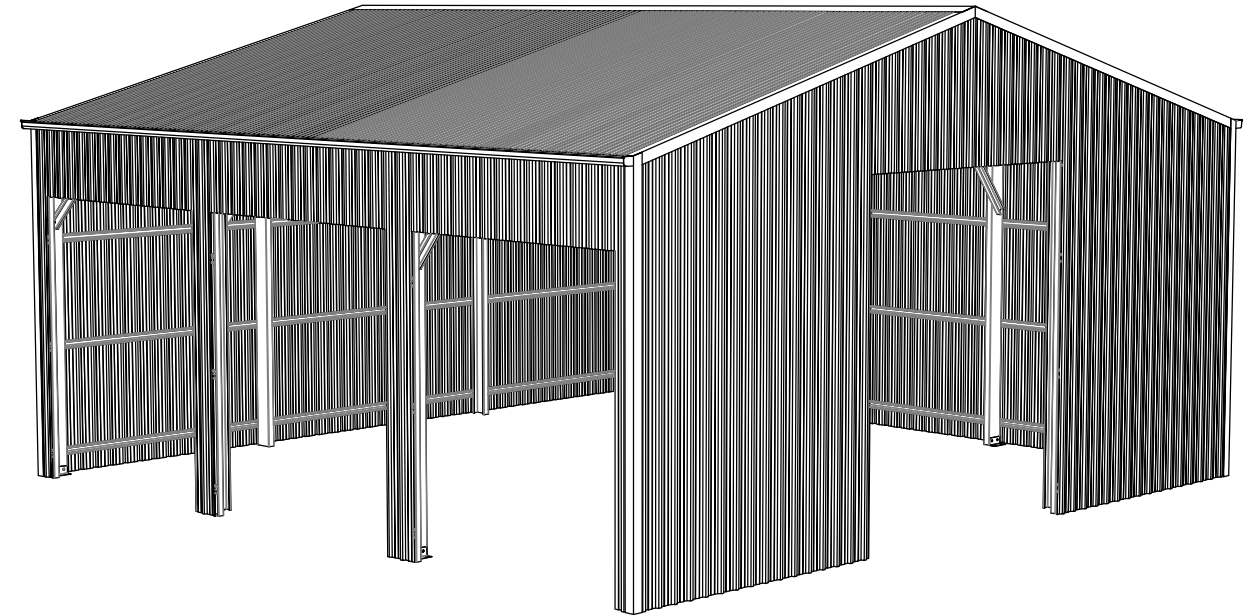

Open FarmShed

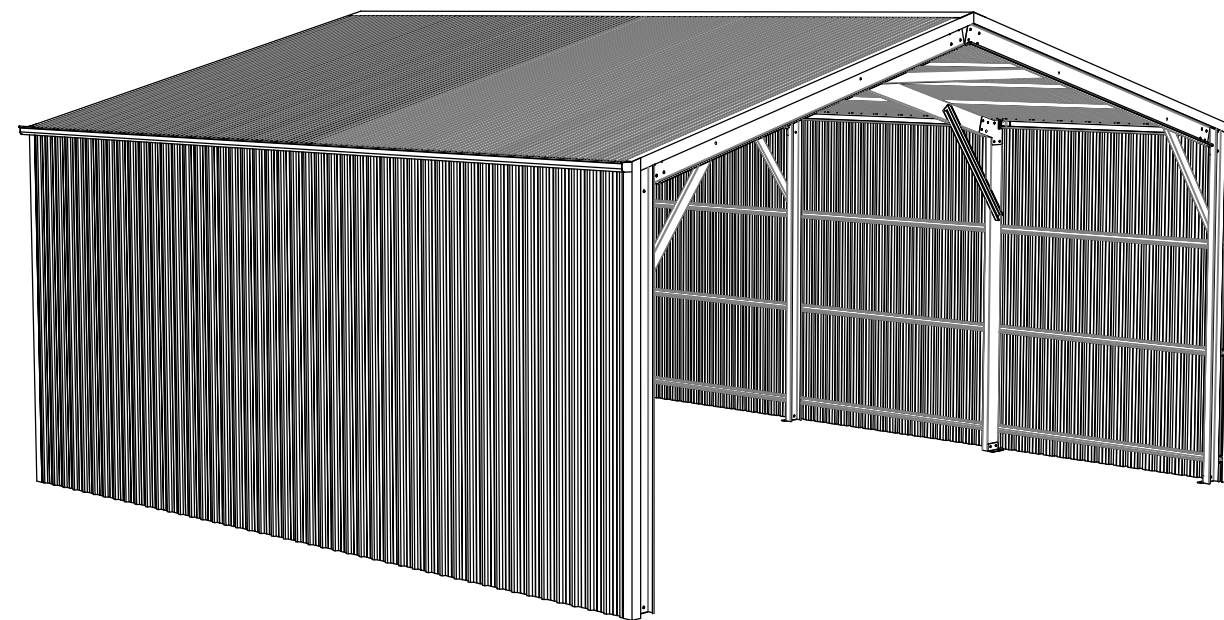

Hanger Shed

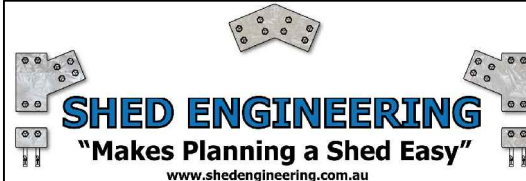

SHED ENGINEERING
"Makes Planning a Shed Easy"
www.shedengineering.com.au



PURLIN BRACKETS
"Makes Building a Shed Easy"
www.purlinbrackets.com.au

Contact: Sam Phone: 0409 023 494 Email: tisam2@yahoo.com.au
Location: Melbourne, Victoria, Australia Web: www.purlinbrackets.com.au

Construction Drawings

Shed Pack / Types of Sheds

Drawing # **S0104.A001**

Drawn By: C.Artemiou

Date Drawn: 28.10.2015

Revision: 0

ALL DIMENSIONS IN MILLIMETERS
UNLESS OTHERWISE STATED

ALL DIMENSIONS TO BE +/- 1mm
UNLESS OTHERWISE STATED

=DISCLAIMER=

– Please read and agree to Purlin Brackets Terms and Conditions before purchasing – if you don't agree to the following Terms and Conditions please do not purchase this product.

Terms and conditions – Legal Disclaimer – Please read before purchasing

Purlin Brackets is not responsible for, and expressly disclaims all liability for injury, loss of life or damages of any kind arising out of use, reference to, or reliance on any information contained within the Purlin Brackets Web Site, Purlin Brackets Ebay Site and Purlin Brackets Documentation supplied with Purlin Brackets Shed Sets. While the information contained within the Purlin Brackets Web Site, Purlin Brackets Ebay Site and Purlin Brackets Documentation supplied with Purlin Brackets Shed Sets is periodically updated, no guarantee is given that the information provided in Purlin Brackets Web Site, Purlin Brackets Ebay Site and Purlin Brackets Documentation supplied with Purlin Brackets Shed Sets is correct, complete, and up-to-date. Purlin Brackets only offers this information contained in Purlin Brackets Web Site, Purlin Brackets Ebay Site and Purlin Brackets Documentation supplied with Purlin Brackets Shed Sets as a guide only reference taken directly from the Australian Standards. Purlin Brackets strictly recommends any information followed by Purlin Brackets Web Site, Purlin Brackets Ebay Site and Purlin Brackets Documentation supplied with Purlin Brackets Shed Sets to be checked and authorized by a fully qualified Engineer and must meet the planning and building approval process of local law applications. Purlin Brackets takes no responsibility for the physical building processes and applications of the information contained in Purlin Brackets Web Site, Purlin Brackets Ebay Site and Purlin Brackets Documentation supplied with Purlin Brackets Shed Sets. Purlin Brackets strictly recommends a qualified Builder to be appointed for the Supervision and Responsibility of assembly of Purlin Brackets Shed Sets.

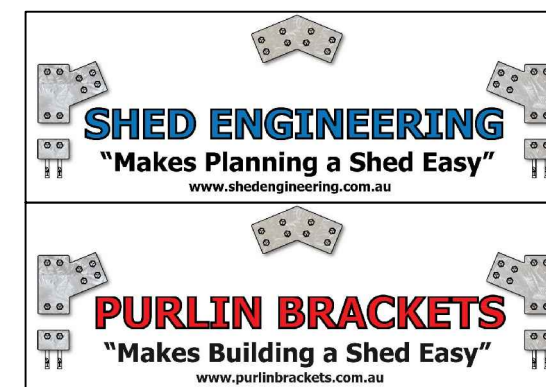

Contact: Sam Phone: 0409 023 494 Email: tisam2@yahoo.com.au
Location: Melbourne, Victoria, Australia Web: www.purlinbrackets.com.au

Construction Drawings

Shed Pack / Types of Sheds

Drawing # **S0104.B001**

Drawn By: C.Artemiou

Date Drawn: 28.10.2015

Revision: 0

ALL DIMENSIONS IN MILLIMETERS
UNLESS OTHERWISE STATED

ALL DIMENSIONS TO BE +/- 1mm
UNLESS OTHERWISE STATED

Overview Page

Step 2: Choose either pad footing layout or strip footing concrete slab layout.

Step 3: Choose your shed width, wall height, shed length and roof pitch.
(5°, 11°, 15° or 22.5°)

Step 4: Choose your portal frame spacing.
a) Standard Single Portal Frames
-3 metre spacing, C150mm or C200mm.
or;

b) Back to Back Portal Frames
-4 metre spacing, C200mm only.
-5 metre spacing, C200mm only.

Step 5: Choose your wall cladding and roof cladding profile types.

Pad Footing Layout

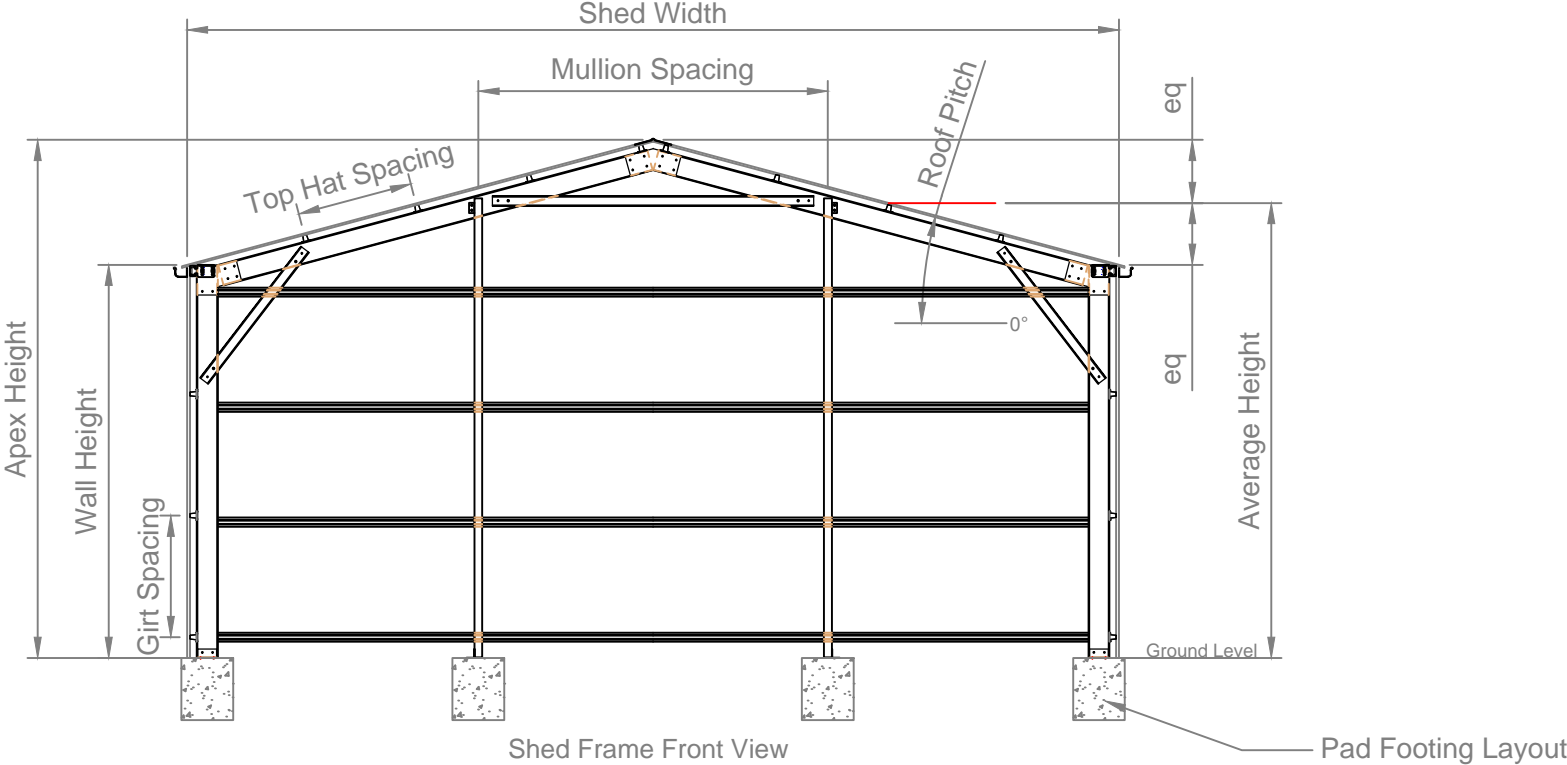

Portal Frame Spacing

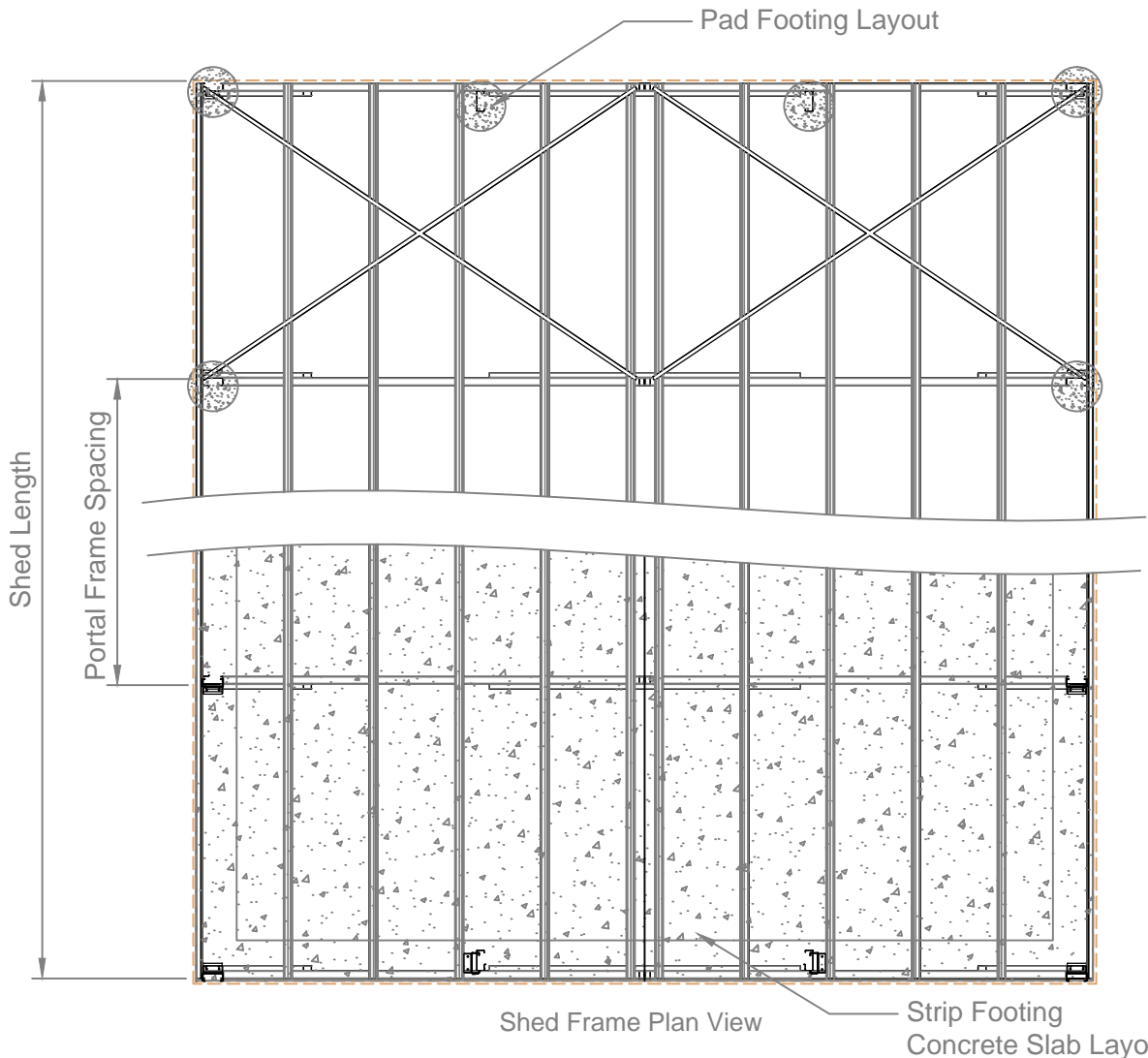

Strip Footing Concrete Slab Layout

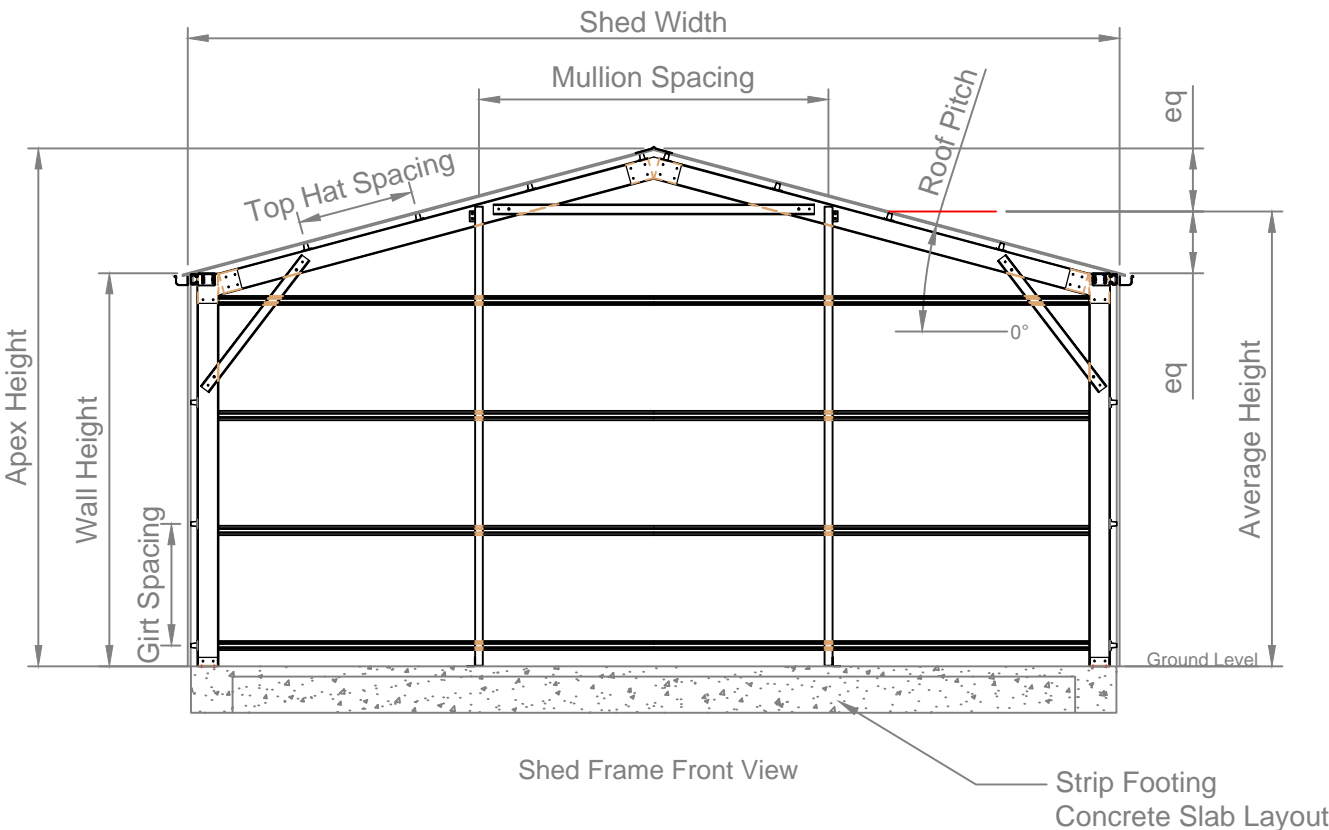

SHED ENGINEERING
"Makes Planning a Shed Easy"
www.shedengineering.com.au

PURLIN BRACKETS
"Makes Building a Shed Easy"
www.purlinbrackets.com.au

Contact: Sam Phone: 0409 023 494 Email: tisam2@yahoo.com.au
Location: Melbourne, Victoria, Australia Web: www.purlinbrackets.com.au

Construction Drawings

Shed Pack / Overview Page

Drawing # **S0104.C001**

Drawn By: C.Artemiou
Date Drawn: 28.10.2015
Revision: 0

ALL DIMENSIONS IN MILLIMETERS
UNLESS OTHERWISE STATED
ALL DIMENSIONS TO BE +/- 1mm
UNLESS OTHERWISE STATED

3m Portal Frame Spacing Purlin Bracket Set

*Engineering certification is compliant in wind region A, B, C and D.

**Suitable for 6" (150mm) and 8" (200mm) C section.

Each portal frame assembly is shipped with the following components

- 1x Apex Bracket, 3mm galvanised steel sheet, G450 - Z350
- 2x Haunch Bracket, 3mm galvanised steel sheet, G450 - Z350
- 2x Footing Plate, 3mm galvanised steel sheet, G450 - Z350
- 28x M16x40mm 8.8 grade structural bolt, galvanised
- 28x M16 8.8 structural nut, galvanised
- 56x M16 8.8 structural washer, galvanised
- 4x M16x105mm Claw Wedge Masonary Anchor, galvanised

4m & 5m Portal Frame Spacing Purlin Bracket Set

*Engineering certification is compliant in wind region A and B only.

**Suitable for 8" (200mm) C section only.

Each portal frame assembly is shipped with the following components

- 2x Apex Bracket, 3mm galvanised steel sheet, G450 - Z350
- 4x Haunch Bracket, 3mm galvanised steel sheet, G450 - Z350
- 4x Footing Plate, 3mm galvanised steel sheet, G450 - Z350
- 28x M16x40mm 8.8 grade structural bolt, galvanised
- 28x M16 8.8 structural nut, galvanised
- 56x M16 8.8 structural washer, galvanised
- 4x M16x105mm Claw Wedge Masonary Anchor, galvanised

*BOLTS INCLUDED IN SET

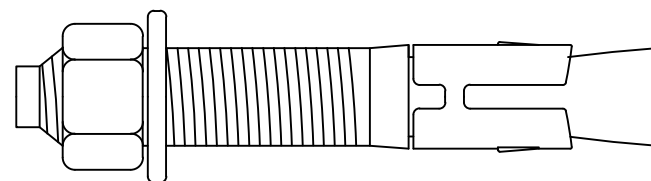

M16x105mm Claw Wedge Masonary Anchor, galvanised

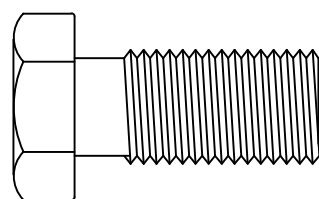

M16x40mm 8.8 grade structural bolt, galvanised

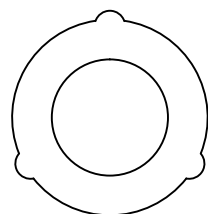

M16 8.8 structural washer, galvanised

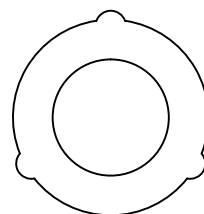

M16 8.8 structural washer, galvanised

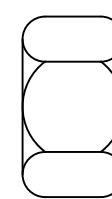

M16 8.8 structural nut, galvanised

M16x40mm 8.8 Structural Assembly, galvanised

*SCREWS TO BE SOURCED BY CUSTOMER

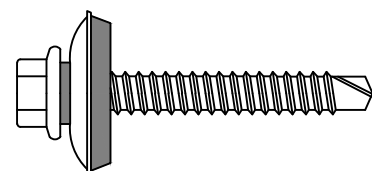

SDM 14-10x50mm HEX BRA
Cyclonic Roof Cladding Screw / Cyclonic Washer

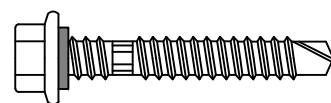

12-14x45mm Class 4
Standard Roof Cladding Screw

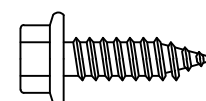

14g-10x25mm Hex Head Needle Point Class 4
use when screwing to metal 0.42 to 1.5mm in thickness

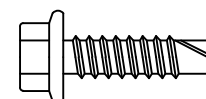

14g-10x25mm Hex Head SDS Class 4
use when screwing to metal 1.5 to 4.0mm in thickness

Contact: Sam Phone: 0409 023 494 Email: tsam2@yahoo.com.au
Location: Melbourne, Victoria, Australia Web: www.purlinbrackets.com.au

Construction Drawings

Shed Pack / Overview Page

Drawing # **S0104.D001**

Drawn By: C.Artemiou

Date Drawn: 28.10.2015

Revision: 0

ALL DIMENSIONS IN MILLIMETERS
UNLESS OTHERWISE STATED

ALL DIMENSIONS TO BE +/- 1mm
UNLESS OTHERWISE STATED

3D Open Farm Shed & 3D Industrial Shed

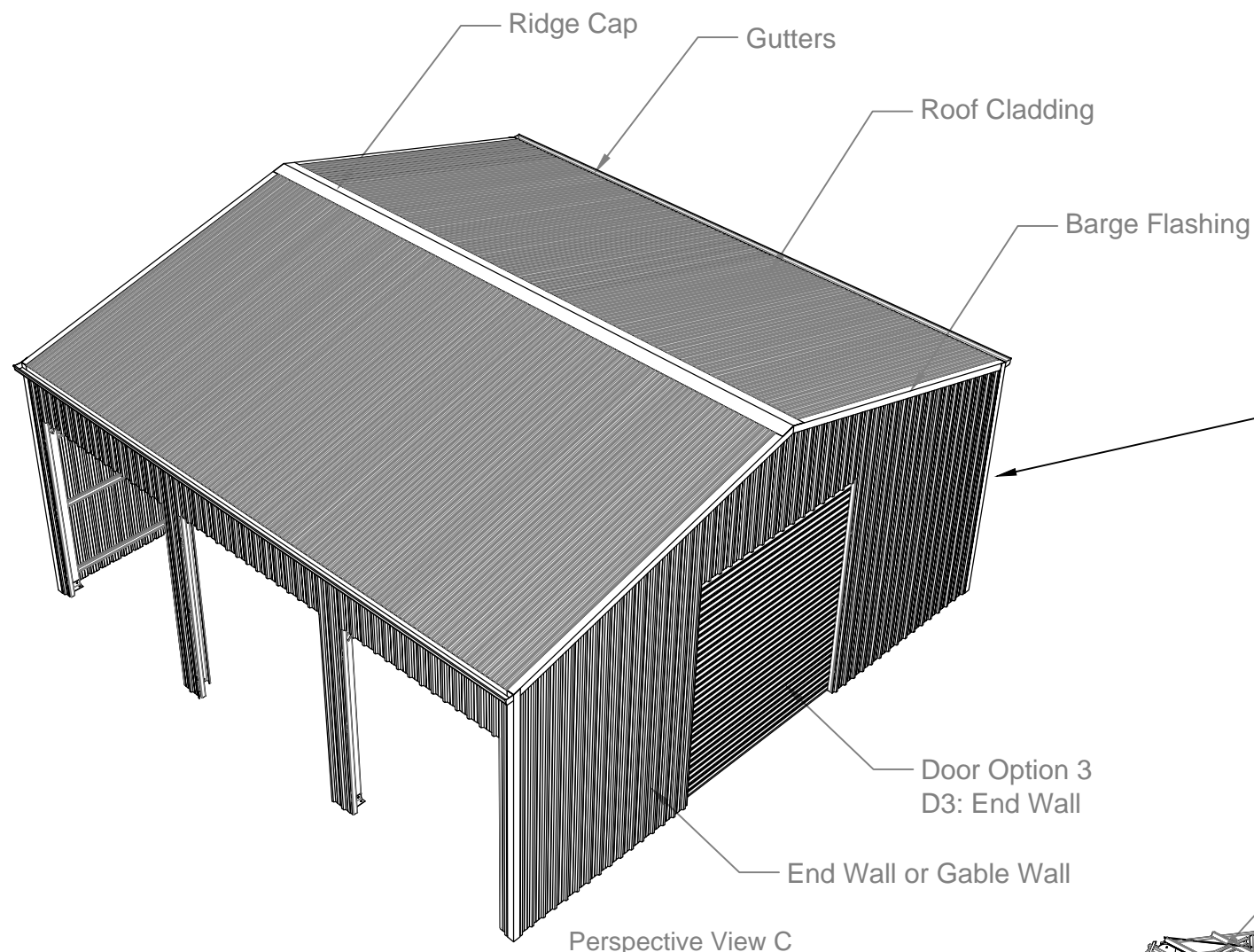

NOTE: THIS IS A GENERIC SHED TO REPRESENT COMPONENTS

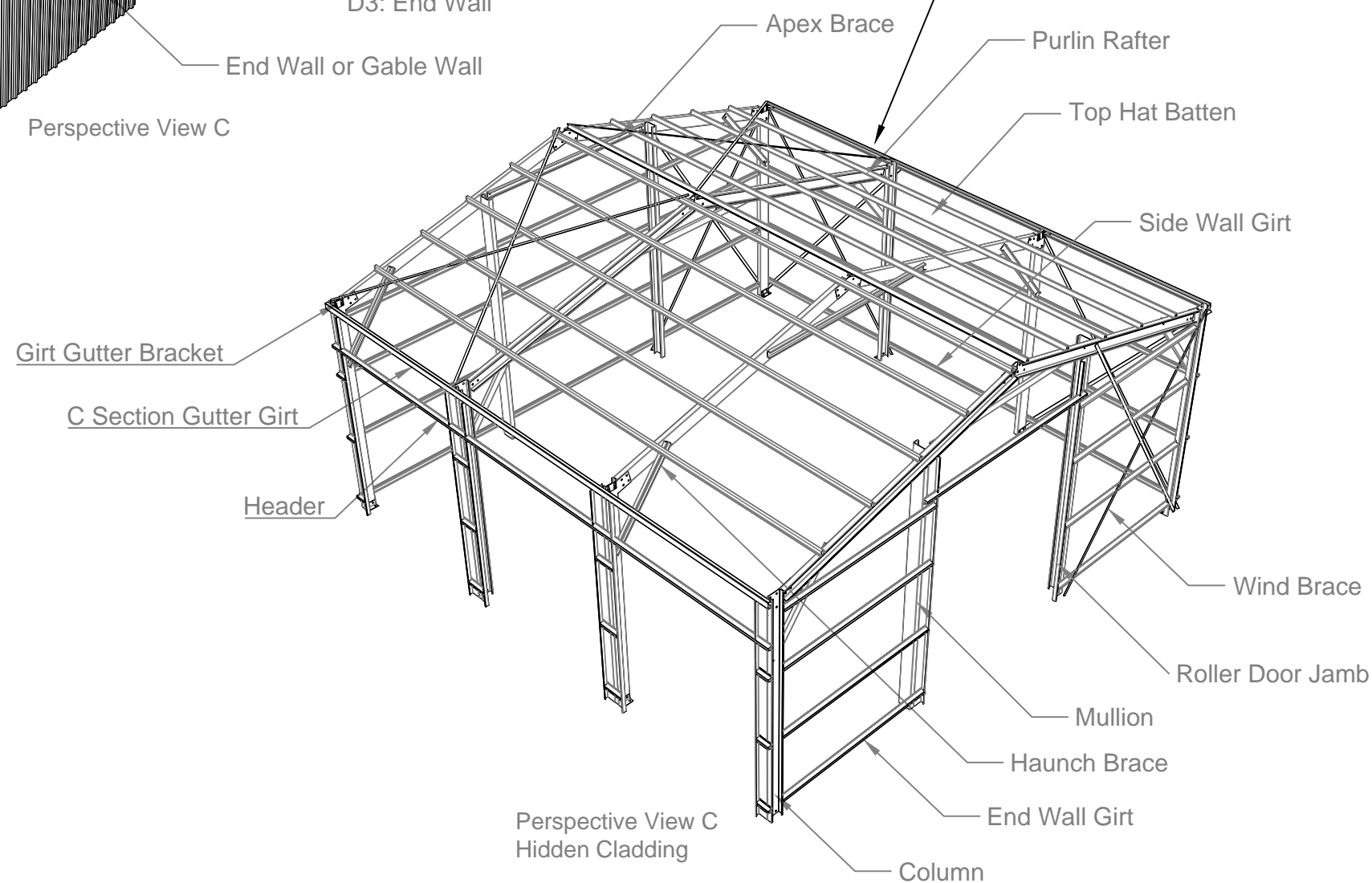

SHED ENGINEERING
"Makes Planning a Shed Easy"
www.shedengineering.com.au

PURLIN BRACKETS
"Makes Building a Shed Easy"
www.purlinbrackets.com.au

Contact: Sam Phone: 0409 023 494 Email: tisam2@yahoo.com.au
Location: Melbourne, Victoria, Australia Web: www.purlinbrackets.com.au

Construction Drawings

Open Farm Shed & Industrial Shed
3D Internal Frame Diagram

Drawing # **S0104.E001**

Drawn By: C.Artemiou
Date Drawn: 28.10.2015
Revision: 0

ALL DIMENSIONS IN MILLIMETERS
UNLESS OTHERWISE STATED

ALL DIMENSIONS TO BE +/- 1mm
UNLESS OTHERWISE STATED

*Example shed only to represent components.

3D Hanger Shed

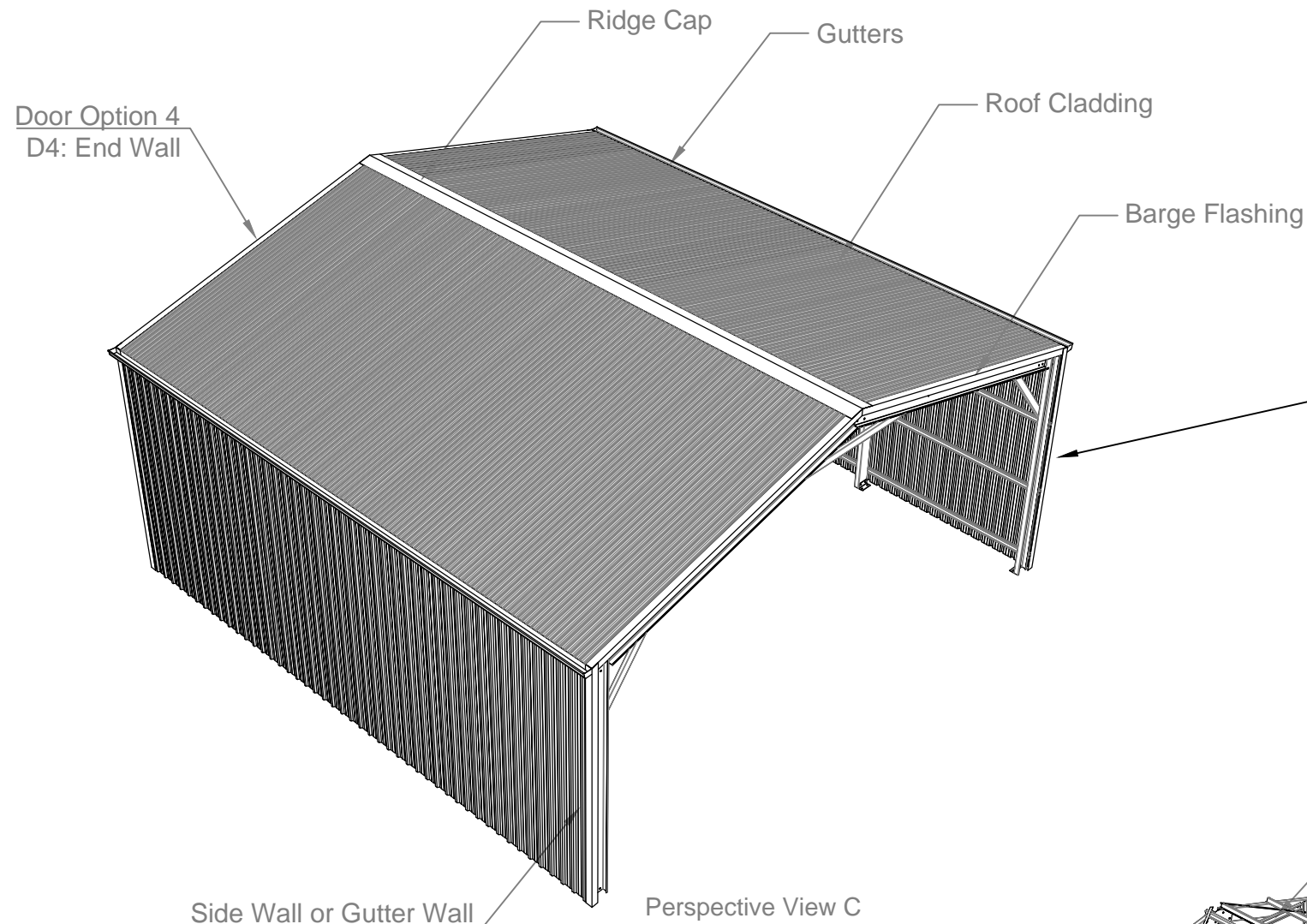

NOTE: THIS IS A GENERIC SHED TO REPRESENT COMPONENTS

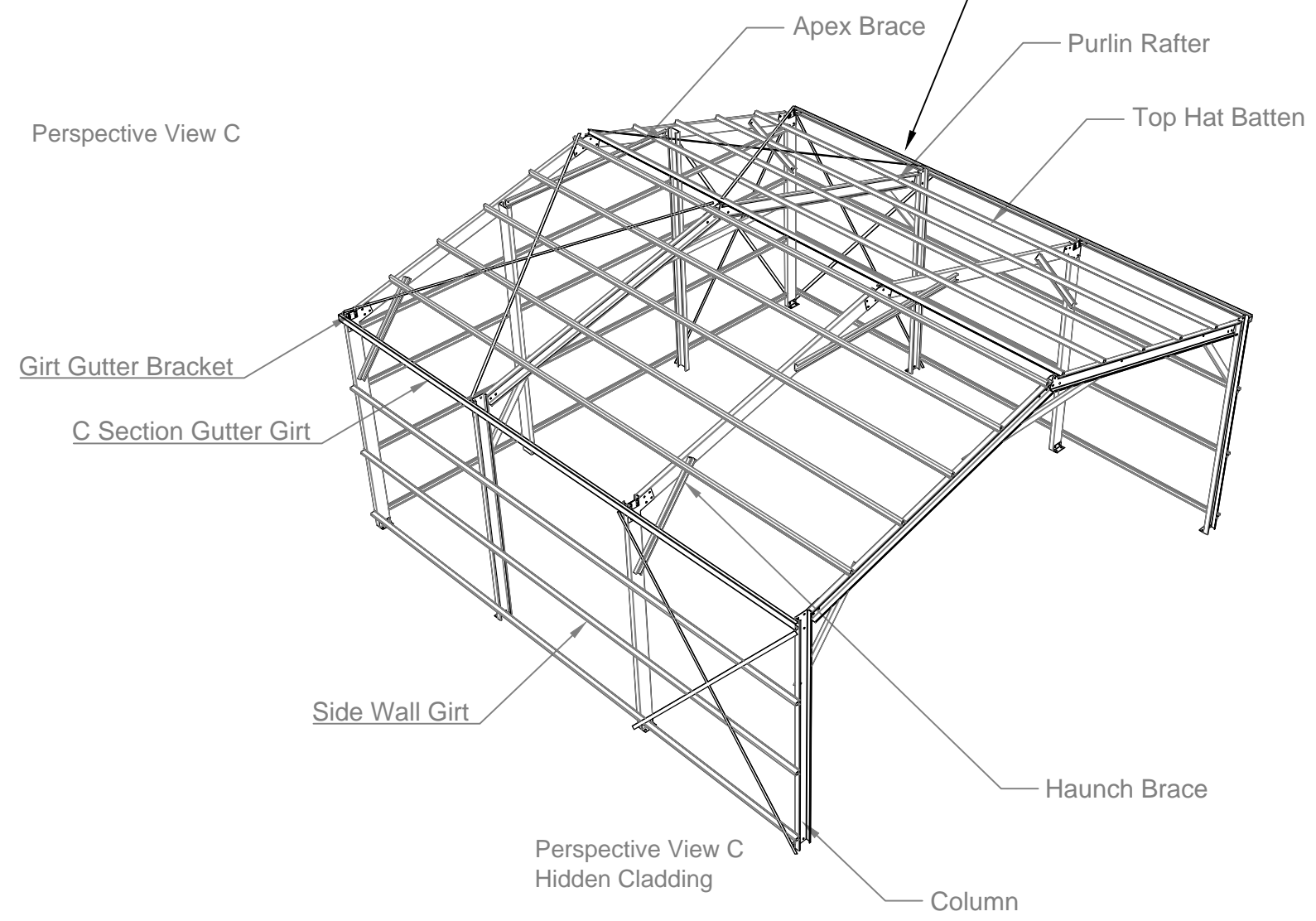

SHED ENGINEERING
"Makes Planning a Shed Easy"
www.shedengineering.com.au

PURLIN BRACKETS
"Makes Building a Shed Easy"
www.purlinbrackets.com.au

Contact: Sam Phone: 0409 023 494 Email: tisam2@yahoo.com.au
Location: Melbourne, Victoria, Australia Web: www.purlinbrackets.com.au

Construction Drawings
Hanger Shed
3D Internal Frame Diagram
Drawing # **S0104.E002**

Drawn By: C.Artemiou
Date Drawn: 28.10.2015
Revision: 0

ALL DIMENSIONS IN MILLIMETERS
UNLESS OTHERWISE STATED

ALL DIMENSIONS TO BE +/- 1mm
UNLESS OTHERWISE STATED

*Example shed only to represent components.

Pad Footing, Open Farm Shed & Pad Footing, Industrial Shed

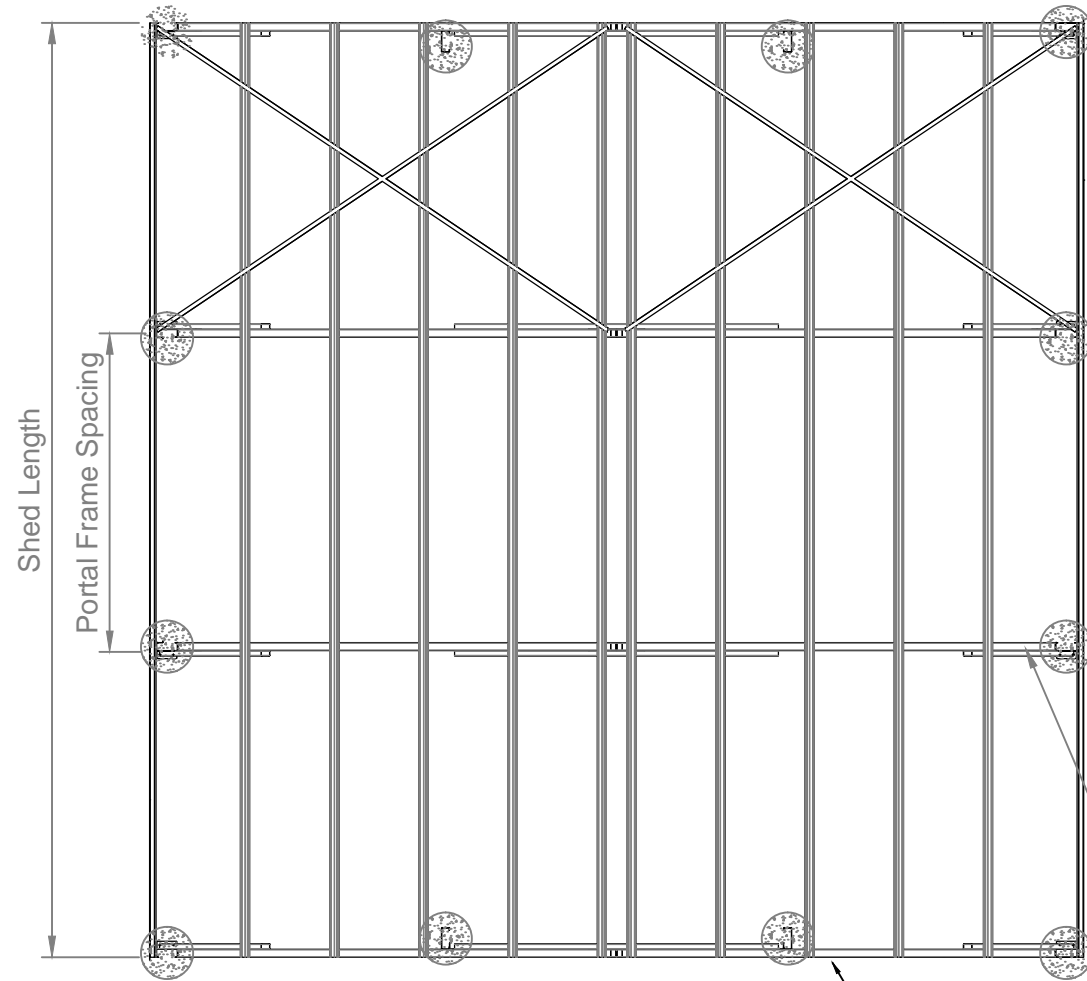

Shed Top View
(Hidden Cladding)

NOTE: THIS IS A GENERIC SHED TO REPRESENT COMPONENTS

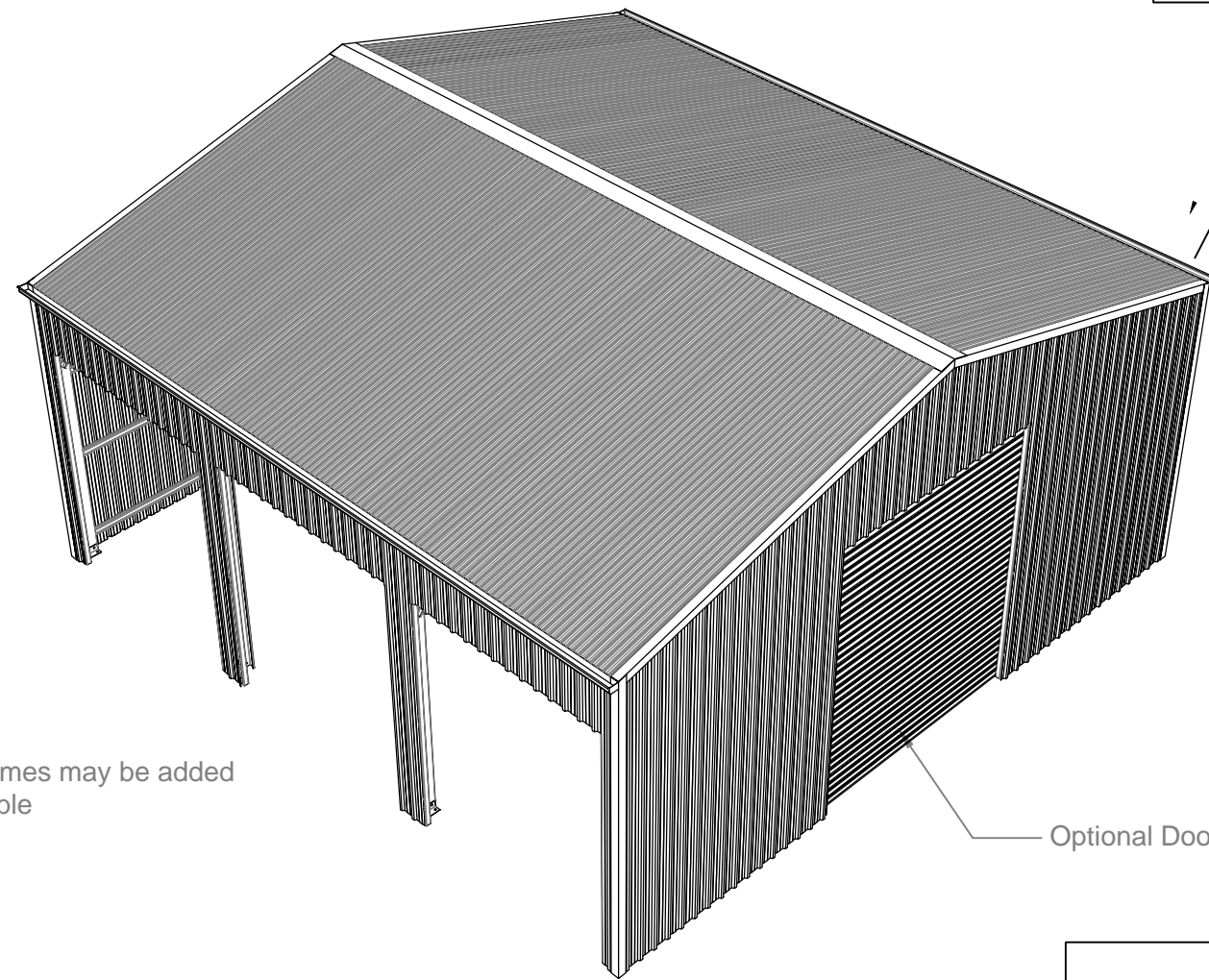

Shed Perspective View

NOTE: THIS IS A GENERIC SHED TO REPRESENT COMPONENTS

Optional Door

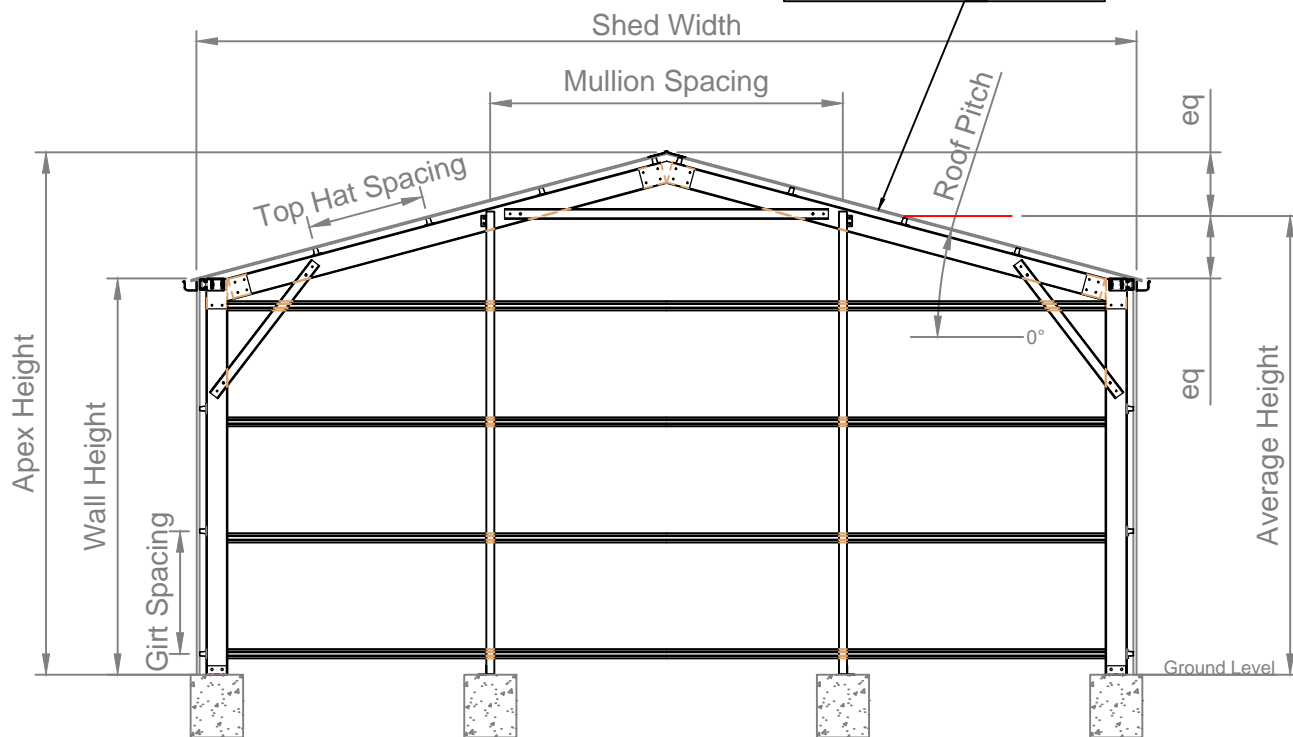

Shed Front View
(Hidden Cladding)

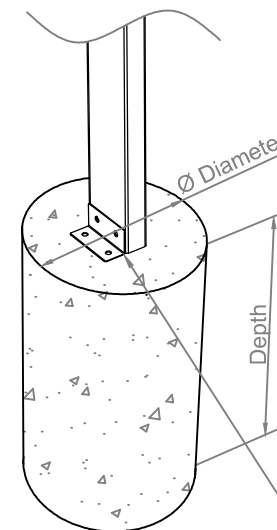

Pad Dimension Detail, View x3
Footing Type: Pad Footing
Concrete Type: 25MPa
Reinforcement: Refer to table

SHED ENGINEERING
"Makes Planning a Shed Easy"
www.shedengineering.com.au

PURLIN BRACKETS
"Makes Building a Shed Easy"
www.purlinbrackets.com.au

Contact: Sam Phone: 0409 023 494 Email: tisam2@yahoo.com.au
Location: Melbourne, Victoria, Australia Web: www.purlinbrackets.com.au

Construction Drawings

Open Farm Shed & Industrial Shed
Pad Footing Layout

Drawing # **S0104.F001**

Drawn By: C.Artemiou

Date Drawn: 28.10.2012

Revision: 0

ALL DIMENSIONS IN MILLIMETERS
UNLESS OTHERWISE STATED

ALL DIMENSIONS TO BE +/- 1mm
UNLESS OTHERWISE STATED

Pad Footing, Hanger Shed

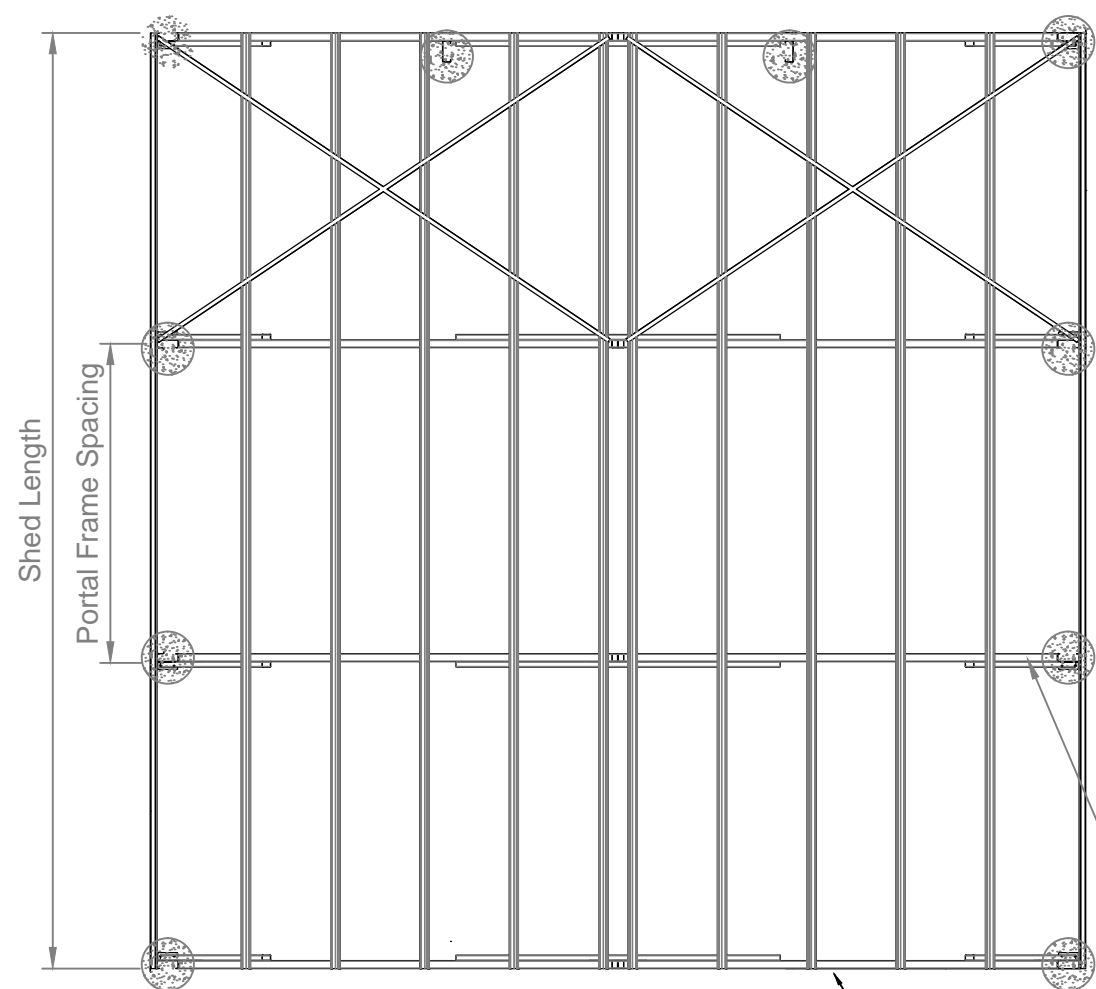

Shed Top View
(Hidden Cladding)

NOTE: THIS IS A GENERIC SHED TO REPRESENT COMPONENTS

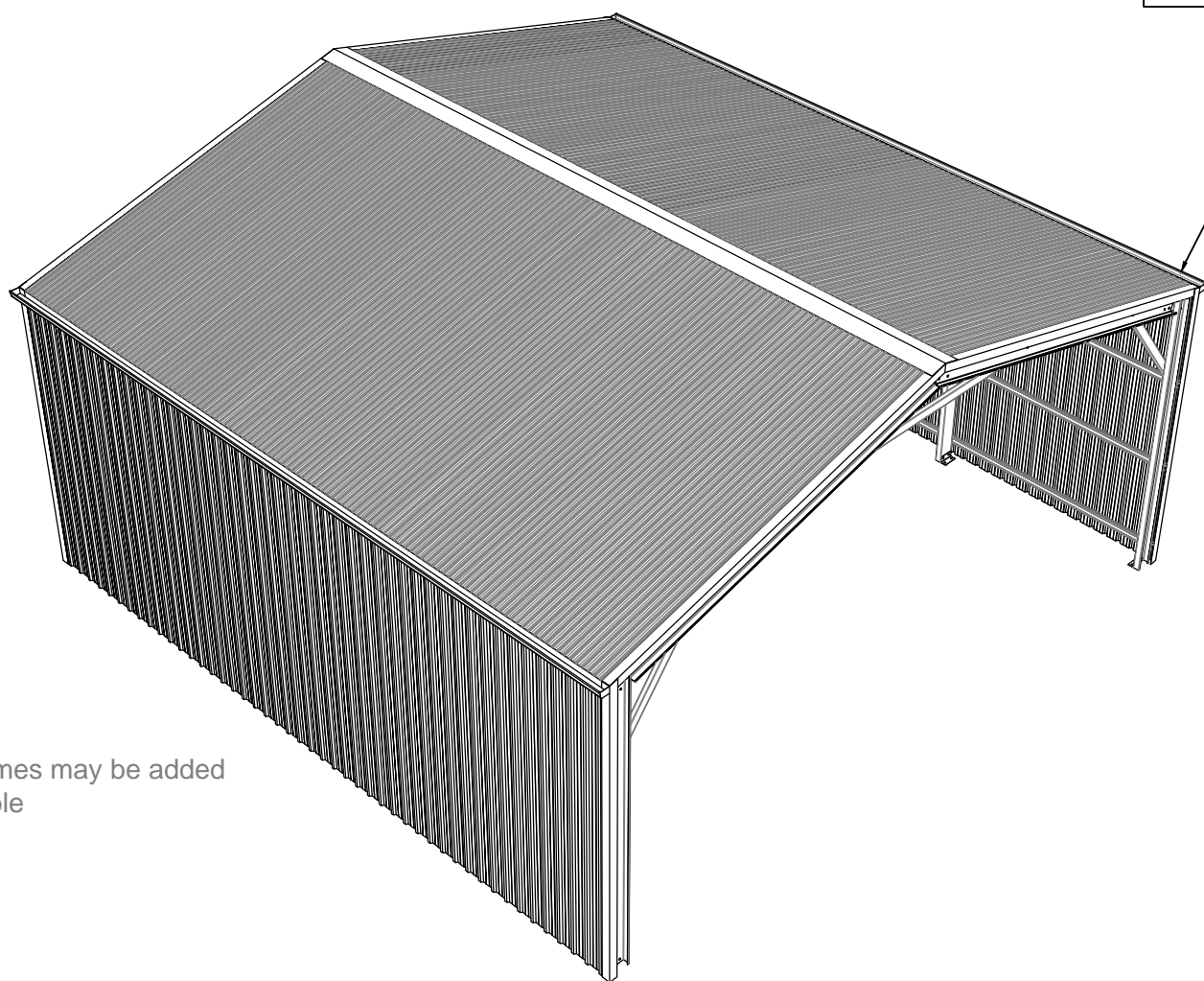

Shed Perspective View

NOTE: THIS IS A GENERIC SHED TO REPRESENT COMPONENTS

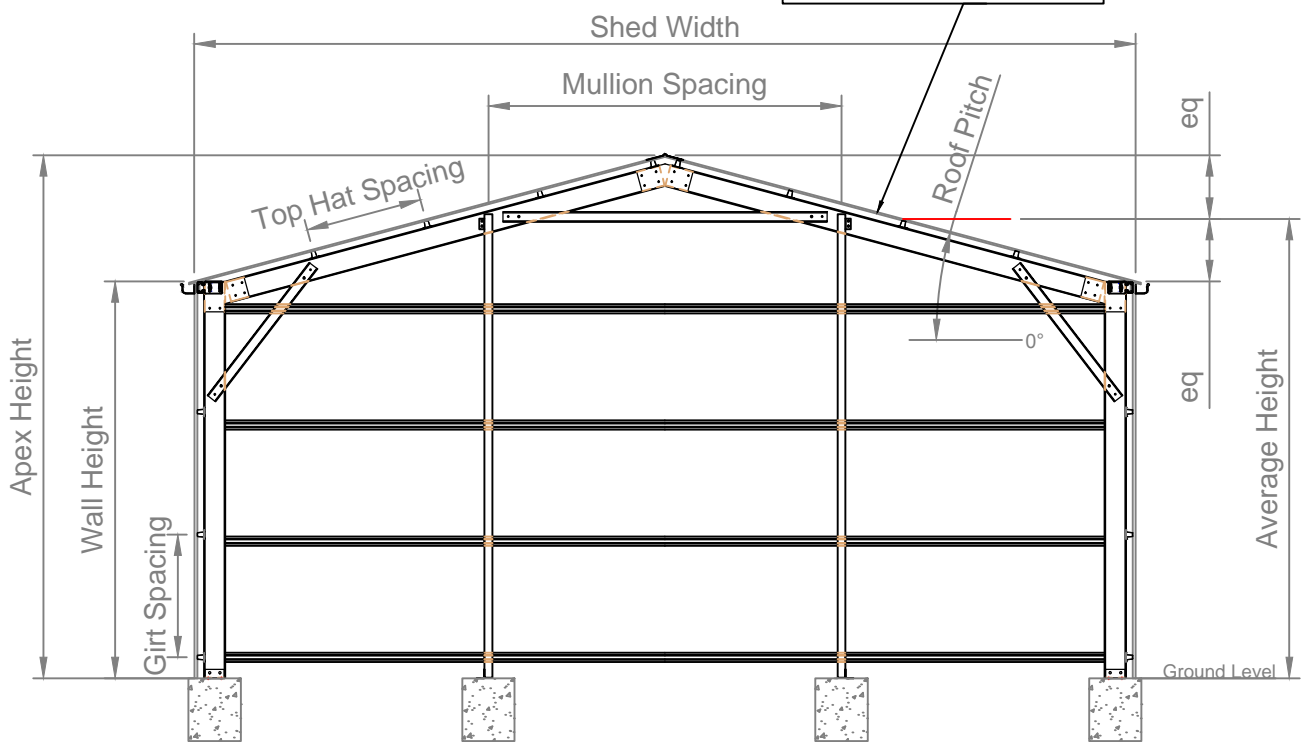

Shed Front View
(Hidden Cladding)

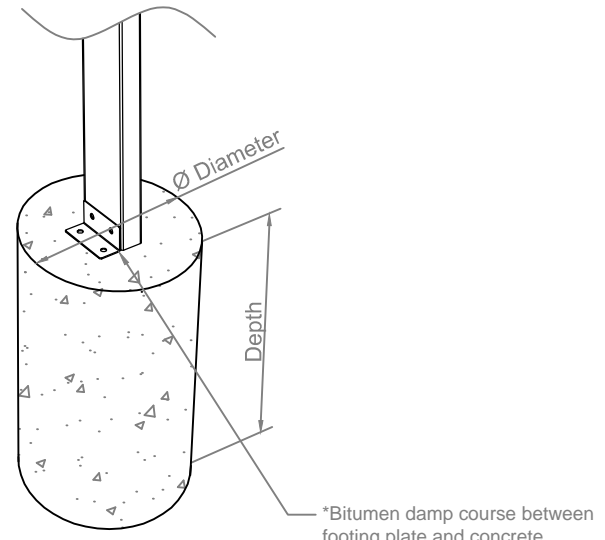

Pad Dimension Detail, View x3
Footing Type: Pad Footing
Concrete Type: 25MPa
Reinforcement: Refer to table

SHED ENGINEERING
"Makes Planning a Shed Easy"
www.shedengineering.com.au

PURLIN BRACKETS
"Makes Building a Shed Easy"
www.purlinbrackets.com.au

Contact: Sam Phone: 0409 023 494 Email: tsam2@yahoo.com.au
Location: Melbourne, Victoria, Australia Web: www.purlinbrackets.com.au

Construction Drawings
Hanger Shed
Pad Footing Layout
Drawing # S0104.F002

Drawn By: C.Artemiou
Date Drawn: 28.10.2012
Revision: 0

ALL DIMENSIONS IN MILLIMETERS
UNLESS OTHERWISE STATED

ALL DIMENSIONS TO BE +/- 1mm
UNLESS OTHERWISE STATED

Strip Footing, Open Farm Shed & Strip Footing, Industrial Shed

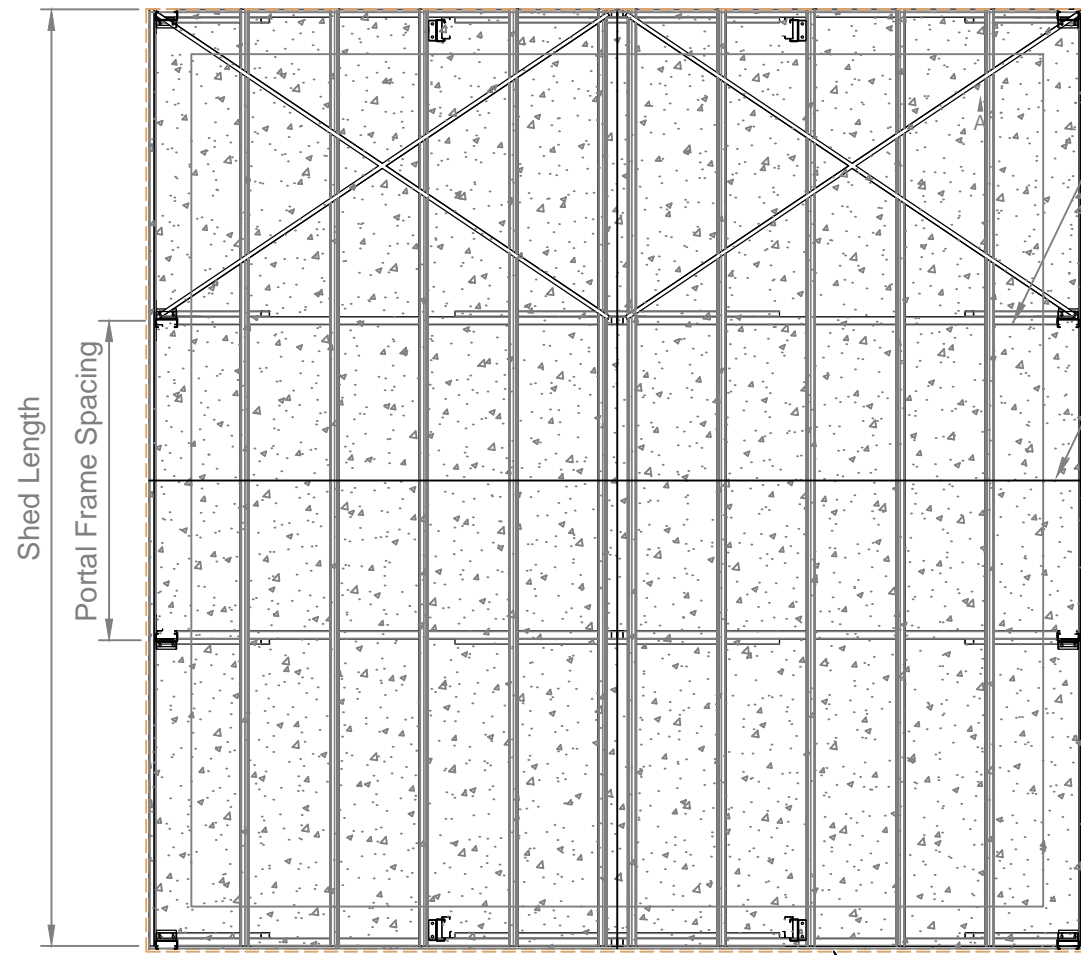

Shed Top View (Hidden Cladding)

NOTE: THIS IS A GENERIC SHED TO REPRESENT COMPONENTS

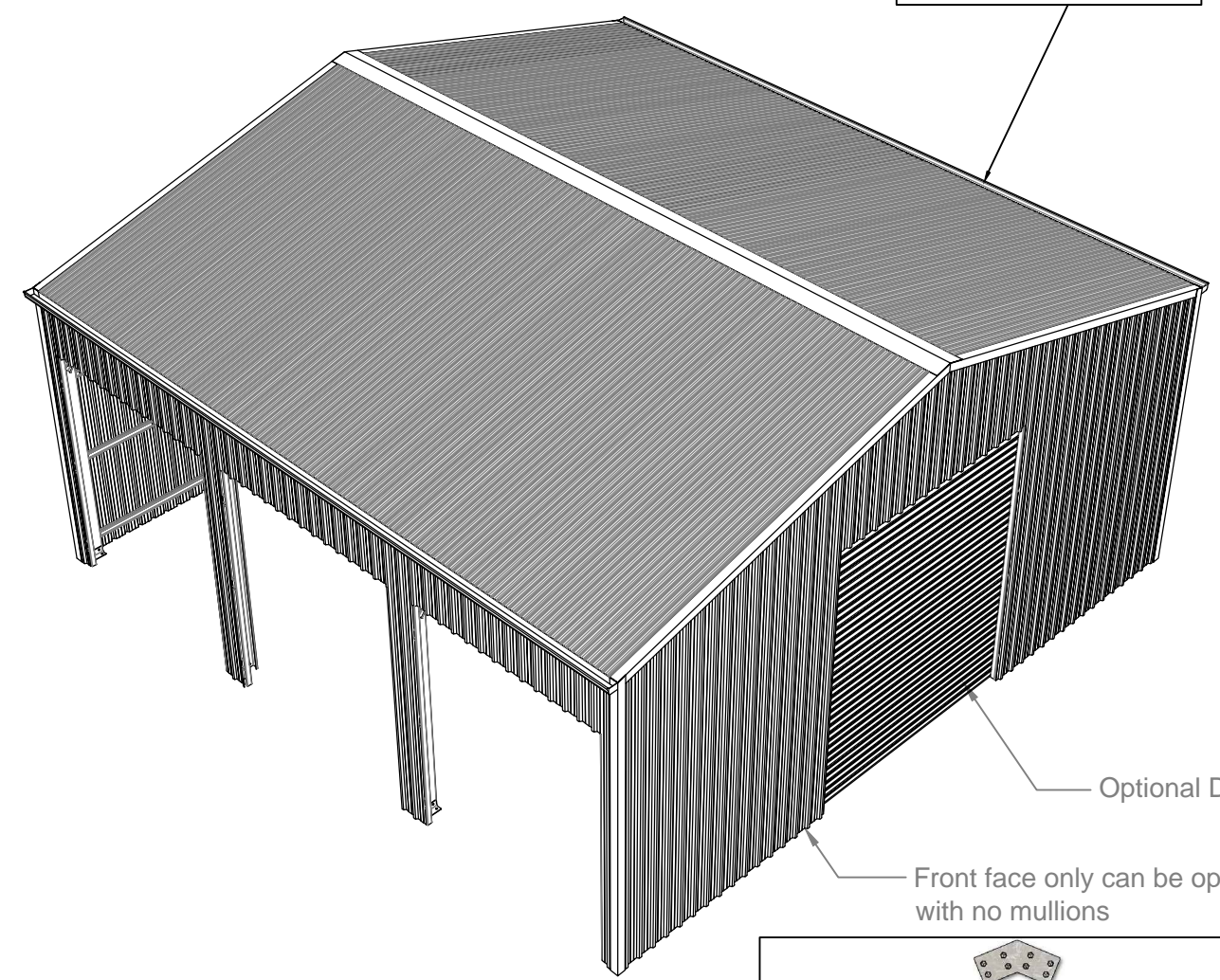

Shed Perspective View

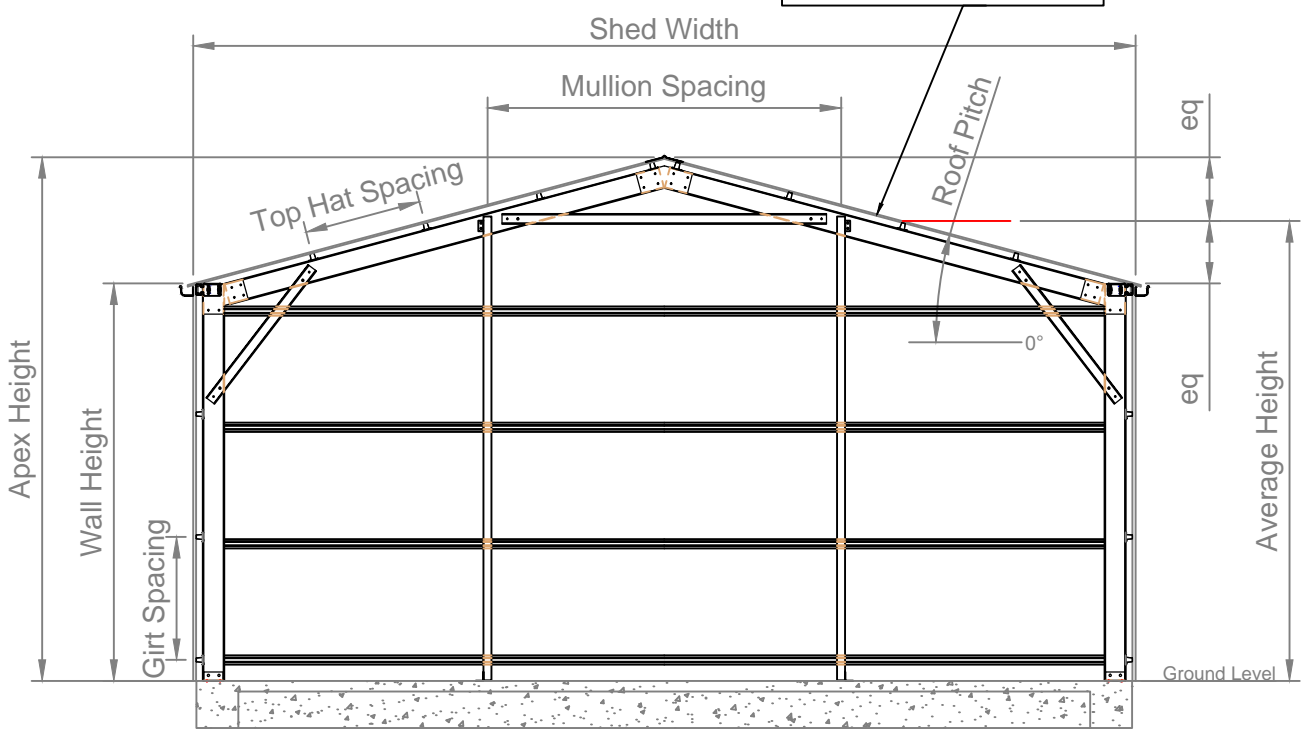

Shed Front View (Hidden Cladding)

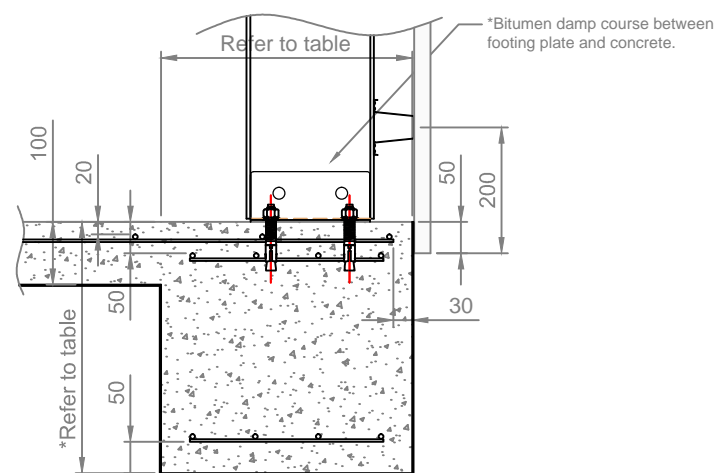

Section A:A, View x6, Soil Class: S, M or H1
 Footing Type: Slab/Strip Footing
 Concrete Type: 25MPa
 Reinforcement: Trench Mesh, *Refer to table
 Slab: SL82 Top only
 Vapour Barrier: 0.2mm Polyethylene Sheet

SHED ENGINEERING
 "Makes Planning a Shed Easy"
 www.shedengineering.com.au

PURLIN BRACKETS
 "Makes Building a Shed Easy"
 www.purlinbrackets.com.au

Contact: Sam Phone: 0409 023 494 Email: tisam2@yahoo.com.au
 Location: Melbourne, Victoria, Australia Web: www.purlinbrackets.com.au

Construction Drawings
 Open Farm Shed & Industrial Shed
 Strip Footing Slab Layout
 Drawing # **S0104.G001**

Drawn By: C.Artemiou
 Date Drawn: 28.10.2012
 Revision: 0

ALL DIMENSIONS IN MILLIMETERS
 UNLESS OTHERWISE STATED
 ALL DIMENSIONS TO BE +/- 1mm
 UNLESS OTHERWISE STATED

Strip Footing, Hanger Shed

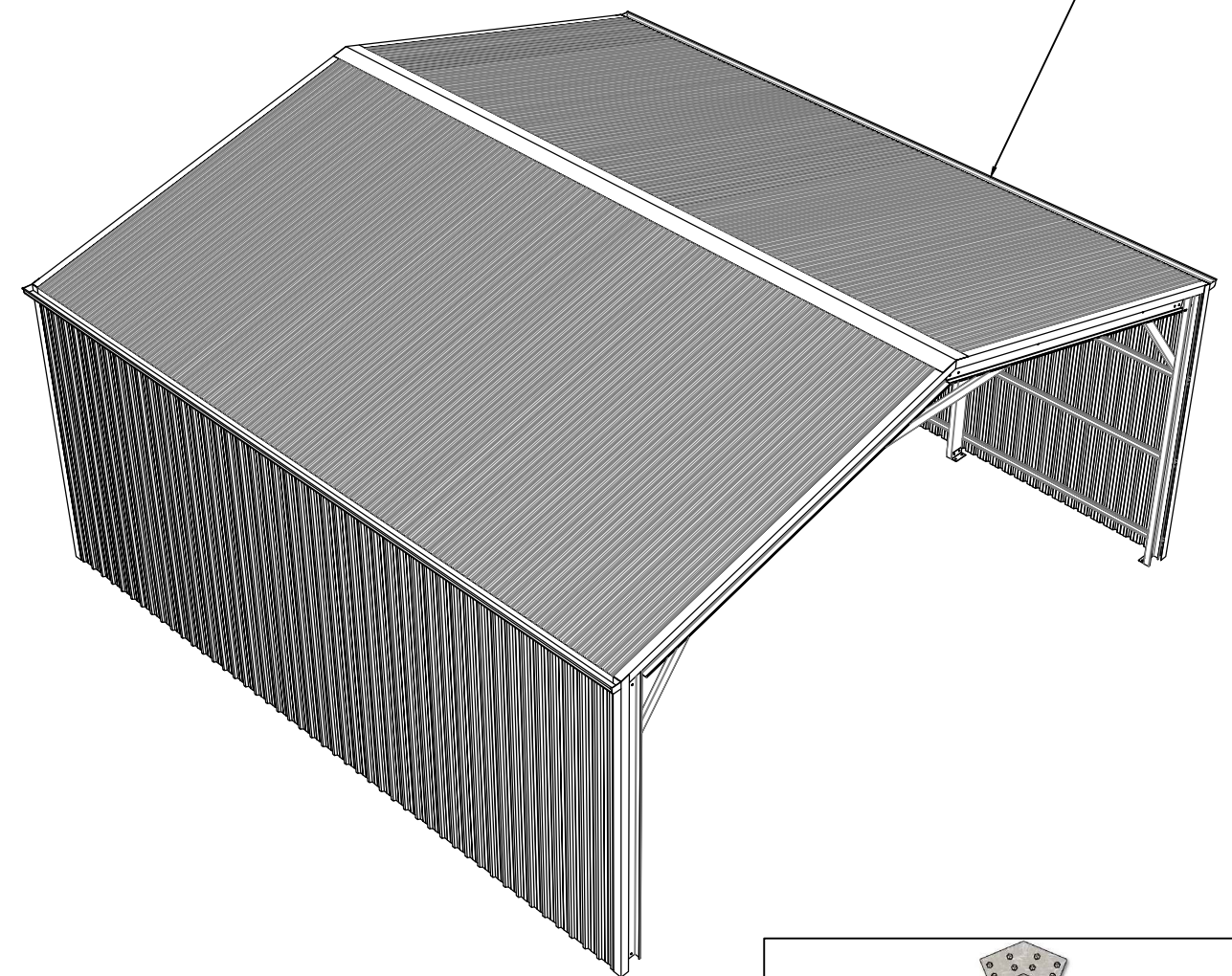
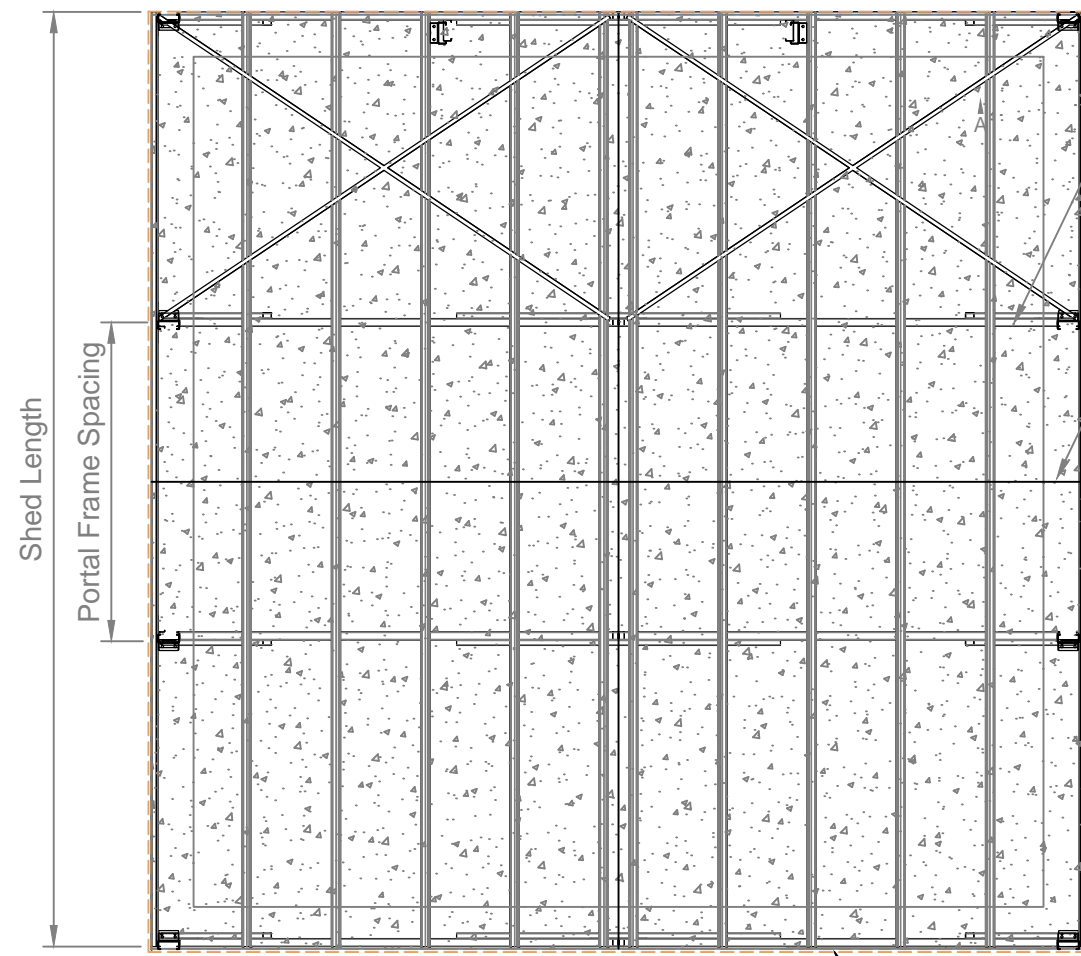

Shed Perspective View

Shed Top View
(Hidden Cladding)

NOTE: THIS IS A GENERIC SHED TO REPRESENT COMPONENTS

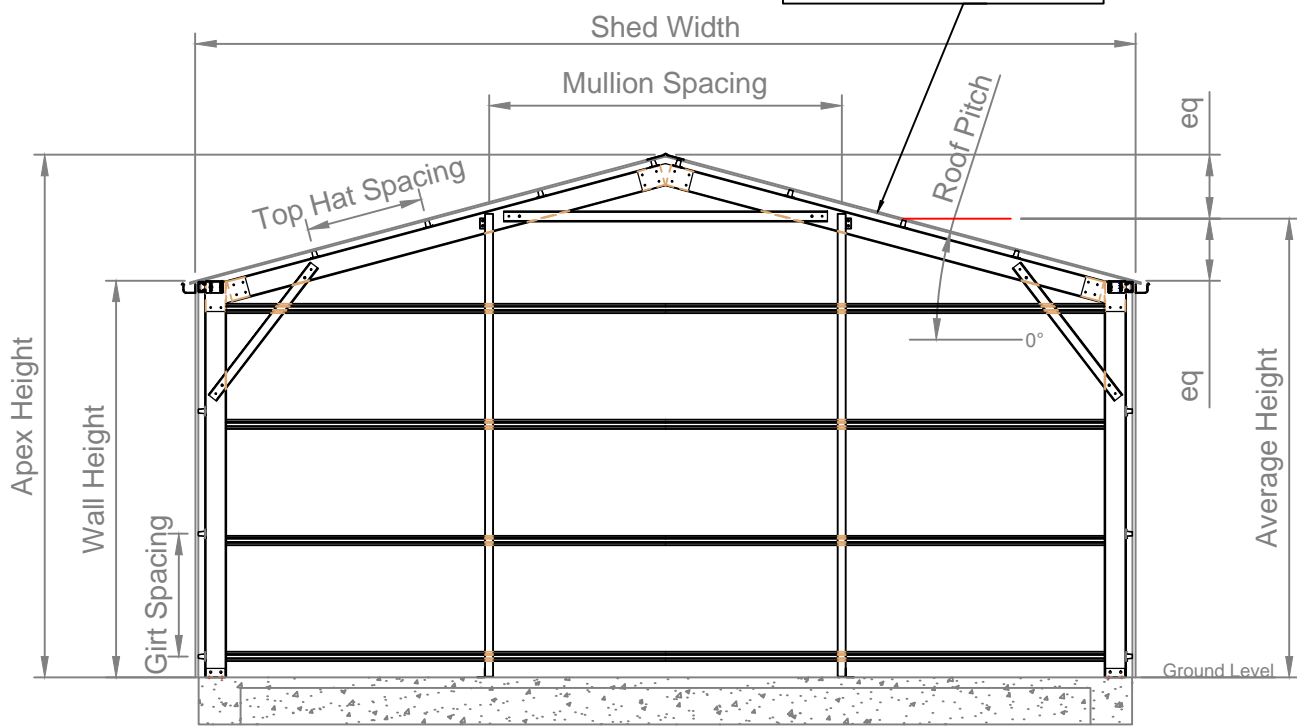

Shed Front View
(Hidden Cladding)

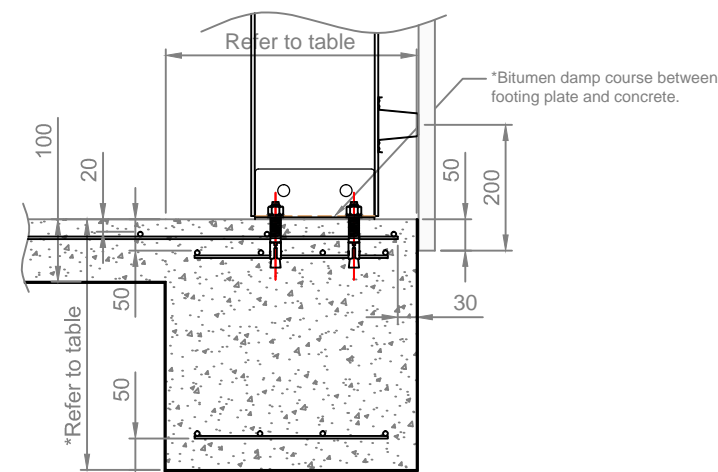

Section A:A, View x6, Soil Class: S, M or H1
 Footing Type: Slab/Strip Footing
 Concrete Type: 25MPa
 Reinforcement: Trench Mesh, *Refer to table
 Slab: SL82 Top only
 Vapour Barrier: 0.2mm Polyethylene Sheet

Contact: Sam Phone: 0409 023 494 Email: tisam2@yahoo.com.au
 Location: Melbourne, Victoria, Australia Web: www.purlinbrackets.com.au

Construction Drawings

Hanger Shed
 Strip Footing Slab Layout
 Drawing # **S0104.G002**

Drawn By: C.Artemiou
 Date Drawn: 28.10.2012

Revision: 0

ALL DIMENSIONS IN MILLIMETERS
 UNLESS OTHERWISE STATED

ALL DIMENSIONS TO BE +/- 1mm
 UNLESS OTHERWISE STATED

*For all details on fixings and fasteners please refer to: S0104.H001 and relevant Wind Region Design Requirements

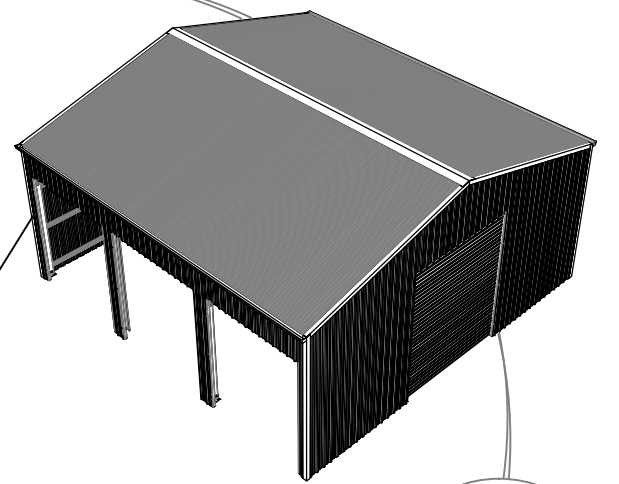
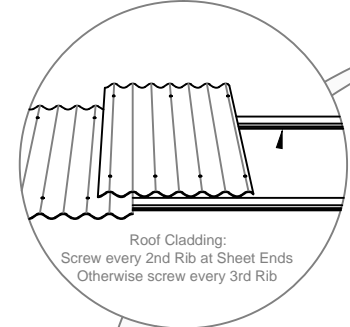
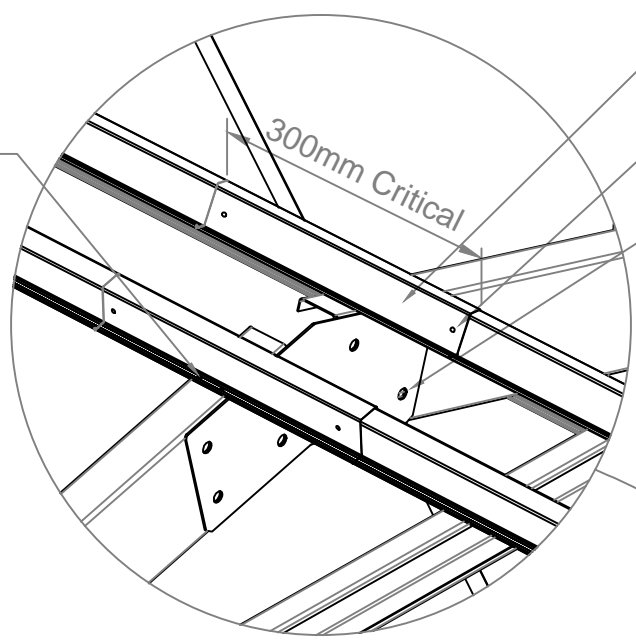
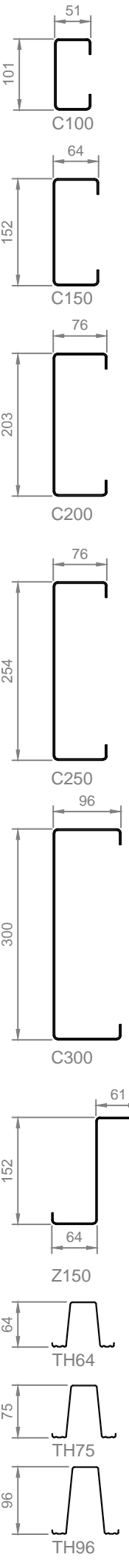

Perspective View C

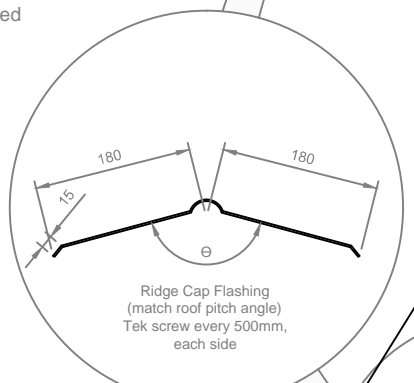

NOTE: THIS IS A GENERIC SHED TO REPRESENT COMPONENTS

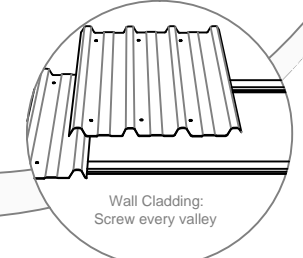
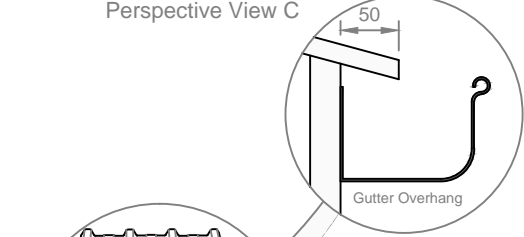
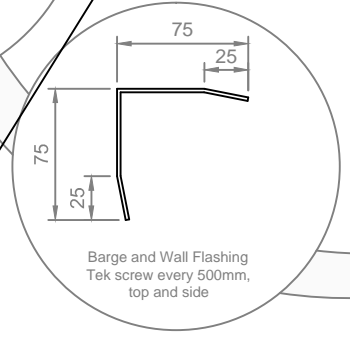

Wind Bracing must be over Top Hat Batten and Wall Girts. qty= Cross brace to 30% per roof plane

Wind Bracing must be over Top Hat Batten and Wall Girts. qty= Cross brace to 30% per wall

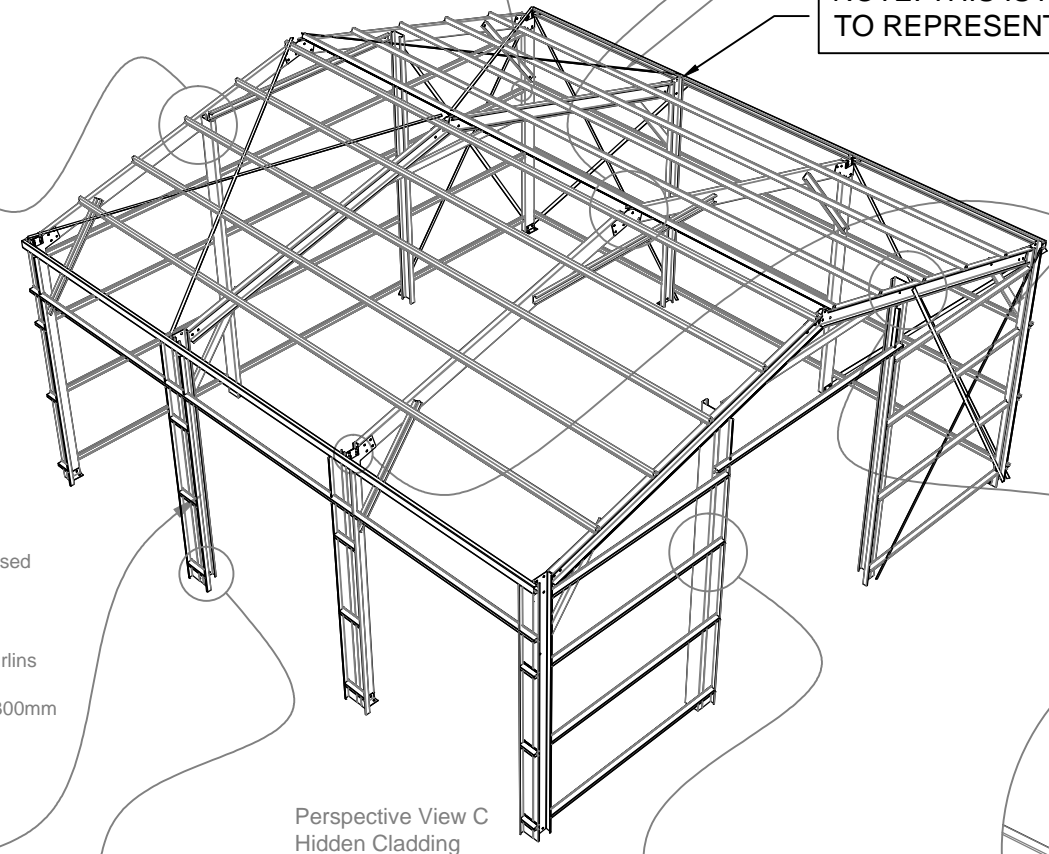

Perspective View C Hidden Cladding

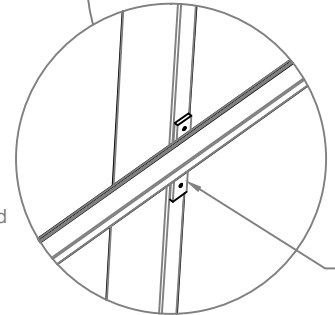
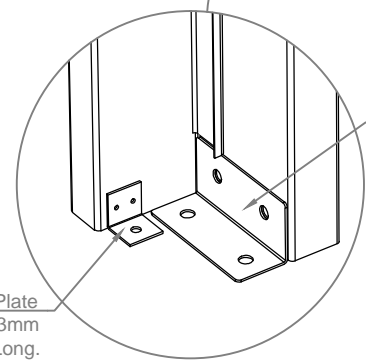
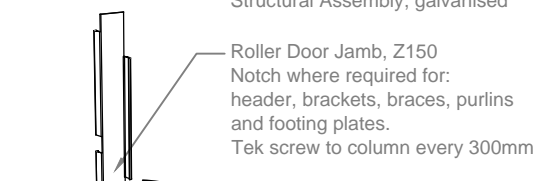
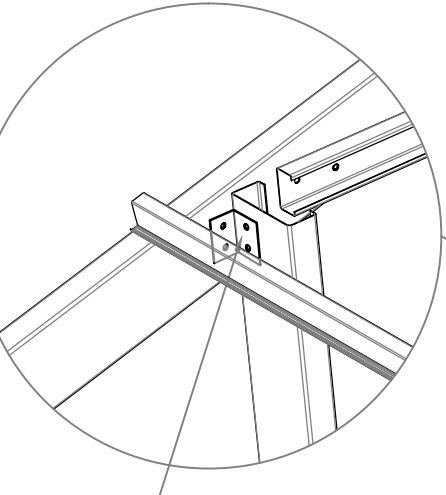
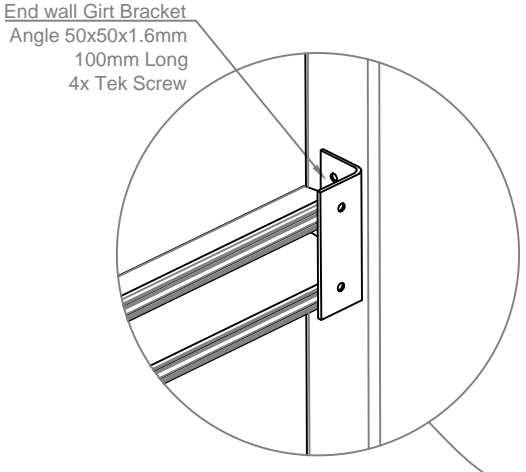

Pack end wall Girts with structural ply, or for greater thickness, use non-compressive material. Alternatively increase Girt top hat size. 2x Tek Screw

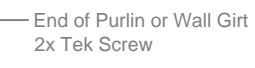
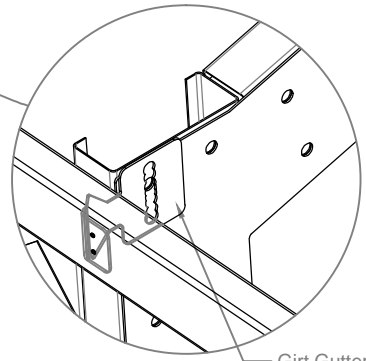

SHED ENGINEERING
"Makes Planning a Shed Easy"
www.shedengineering.com.au

PURLIN BRACKETS
"Makes Building a Shed Easy"
www.purlinbrackets.com.au

Contact: Sam Phone: 0409 023 494 Email: tisam2@yahoo.com.au
Location: Melbourne, Victoria, Australia Web: www.purlinbrackets.com.au

Construction Drawings
Open Farm Shed & Industrial Shed
3D Connection Diagram
Drawing # S0104.H001

Drawn By: C.Artemiou
Date Drawn: 28.10.2015
Revision: 0

ALL DIMENSIONS IN MILLIMETERS
UNLESS OTHERWISE STATED
ALL DIMENSIONS TO BE +/- 1mm
UNLESS OTHERWISE STATED

*Example shed only to represent components.

*For all details on fixings and fasteners please refer to: S0104.H001 and relevant Wind Region Design Requirements

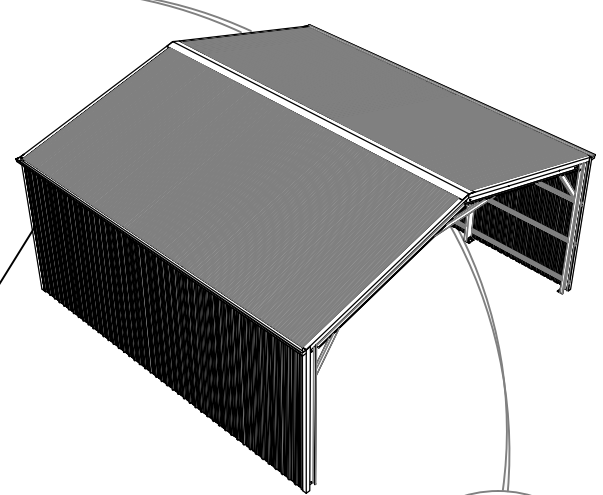
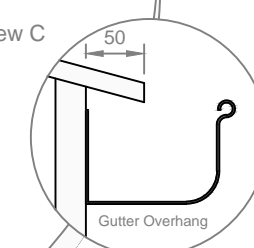
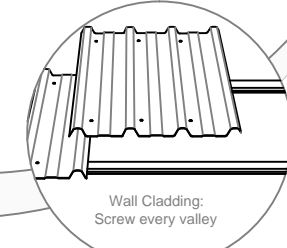
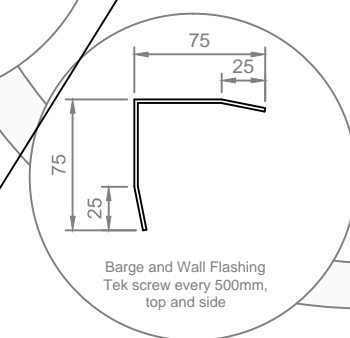
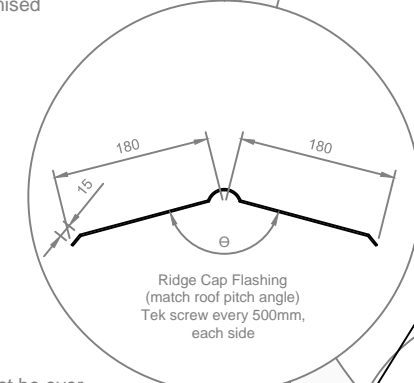
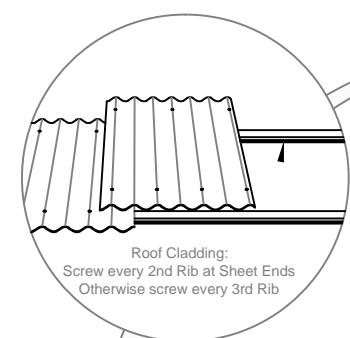
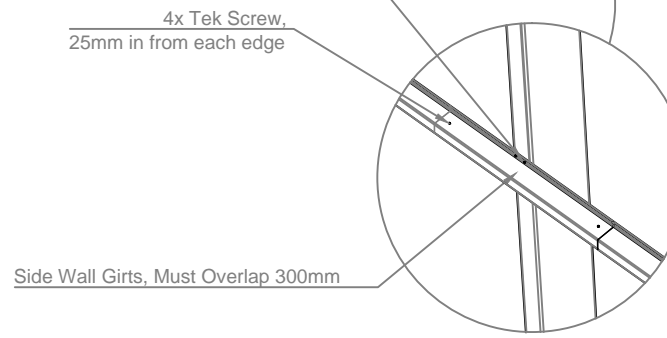
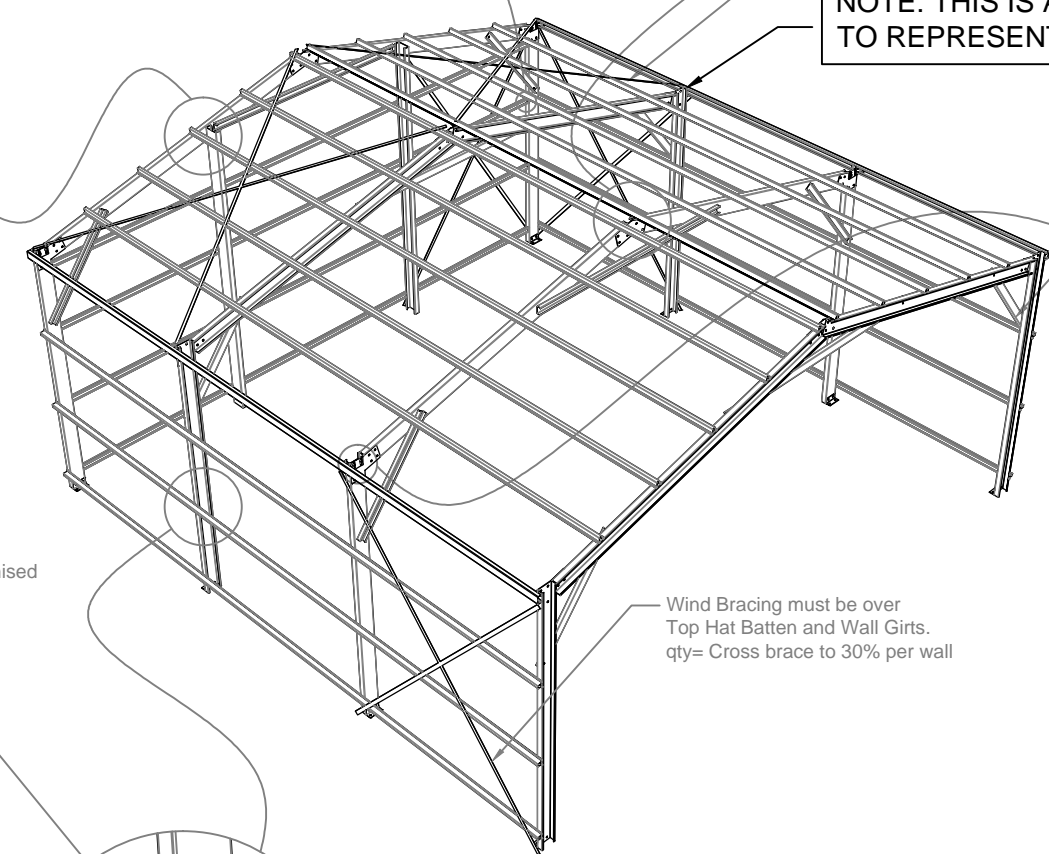
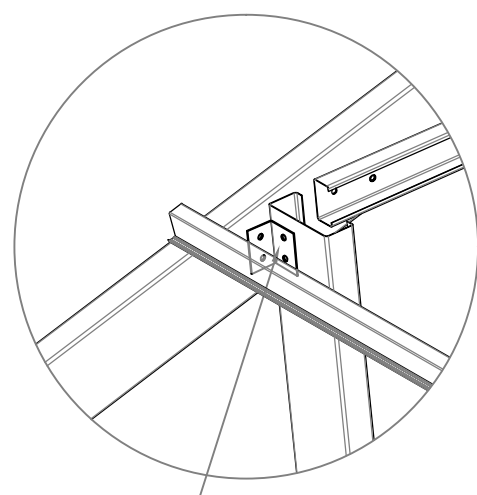
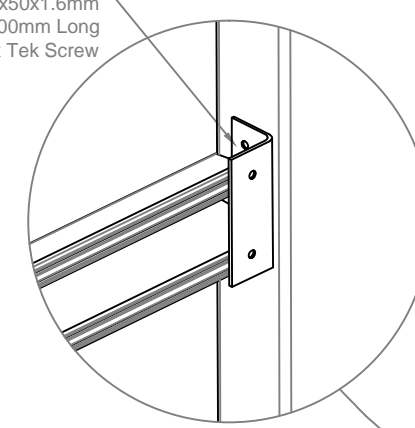
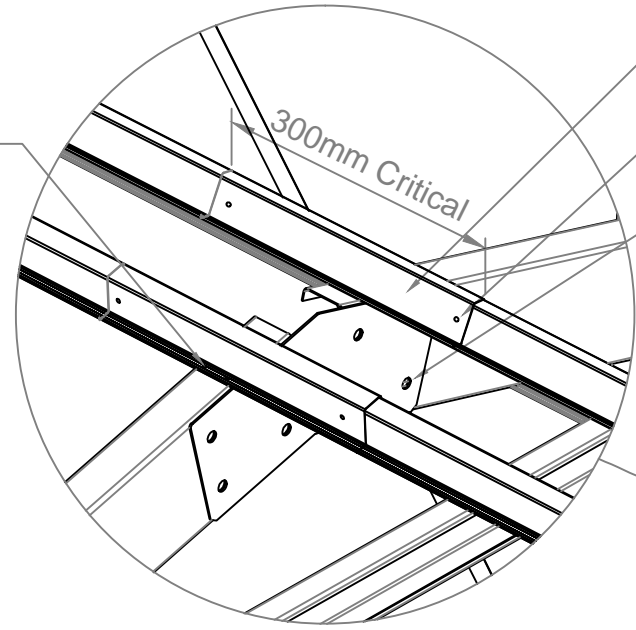
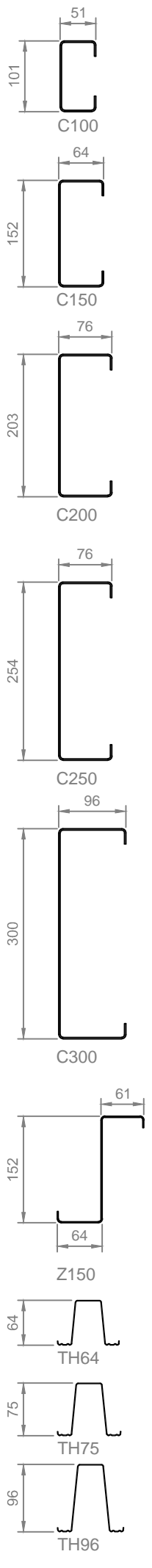

NOTE: THIS IS A GENERIC SHED TO REPRESENT COMPONENTS

SHED ENGINEERING
"Makes Planning a Shed Easy"
www.shedengineering.com.au

PURLIN BRACKETS
"Makes Building a Shed Easy"
www.purlinbrackets.com.au

Contact: Sam Phone: 0409 023 494 Email: tisam2@yahoo.com.au
Location: Melbourne, Victoria, Australia Web: www.purlinbrackets.com.au

Construction Drawings
Hanger Shed
3D Connection Diagram
Drawing # S0104.H002

Drawn By: C.Artemiou
Date Drawn: 28.10.2015
Revision: 0

ALL DIMENSIONS IN MILLIMETERS
UNLESS OTHERWISE STATED
ALL DIMENSIONS TO BE +/- 1mm
UNLESS OTHERWISE STATED

*Example shed only to represent components.

Single end wall portal frames - 3m spacings

****Suitable for 150mm/6" and 200mm/8" C Section**

© Copyright, Purlin Brackets 2016

Single Rafters

Single Mullions

Single Columns

1x Apex Bracket
8x Structural Assembly

Detail
view x5

1x Haunch Bracket
1x Compact Gutter Girt (optional)
8x Structural Assembly

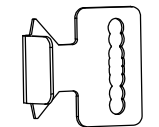

Optional:
Compact Gutter Girt Bracket

Detail
view x5

Detail
view x5

1x Mullion Footing Plate
2x Structural Assembly
2x Masonry Anchor

Detail
view x5

1x Footing Plate
2x Structural Assembly
2x Masonry Anchor

SHED ENGINEERING
"Makes Planning a Shed Easy"
www.shedengineering.com.au

PURLIN BRACKETS
"Makes Building a Shed Easy"
www.purlinbrackets.com.au

Contact: Sam Phone: 0409 023 494 Email: tisam2@yahoo.com.au
Location: Melbourne, Victoria, Australia Web: www.purlinbrackets.com.au

Construction Drawings

Single Portal Frame, with Mullions

Drawing # **S0104.I001**

Drawn By: C.Artemiou

Date Drawn: 28.10.2015

Revision: 0

SHEET 1 of 1

ALL DIMENSIONS IN MILLIMETERS
UNLESS OTHERWISE STATED

ALL DIMENSIONS TO BE +/- 1mm
UNLESS OTHERWISE STATED

Single internal portal frames - 3m spacings

****Suitable for 150mm/6" and 200mm/8" C Section**

© Copyright, Purlin Brackets 2016

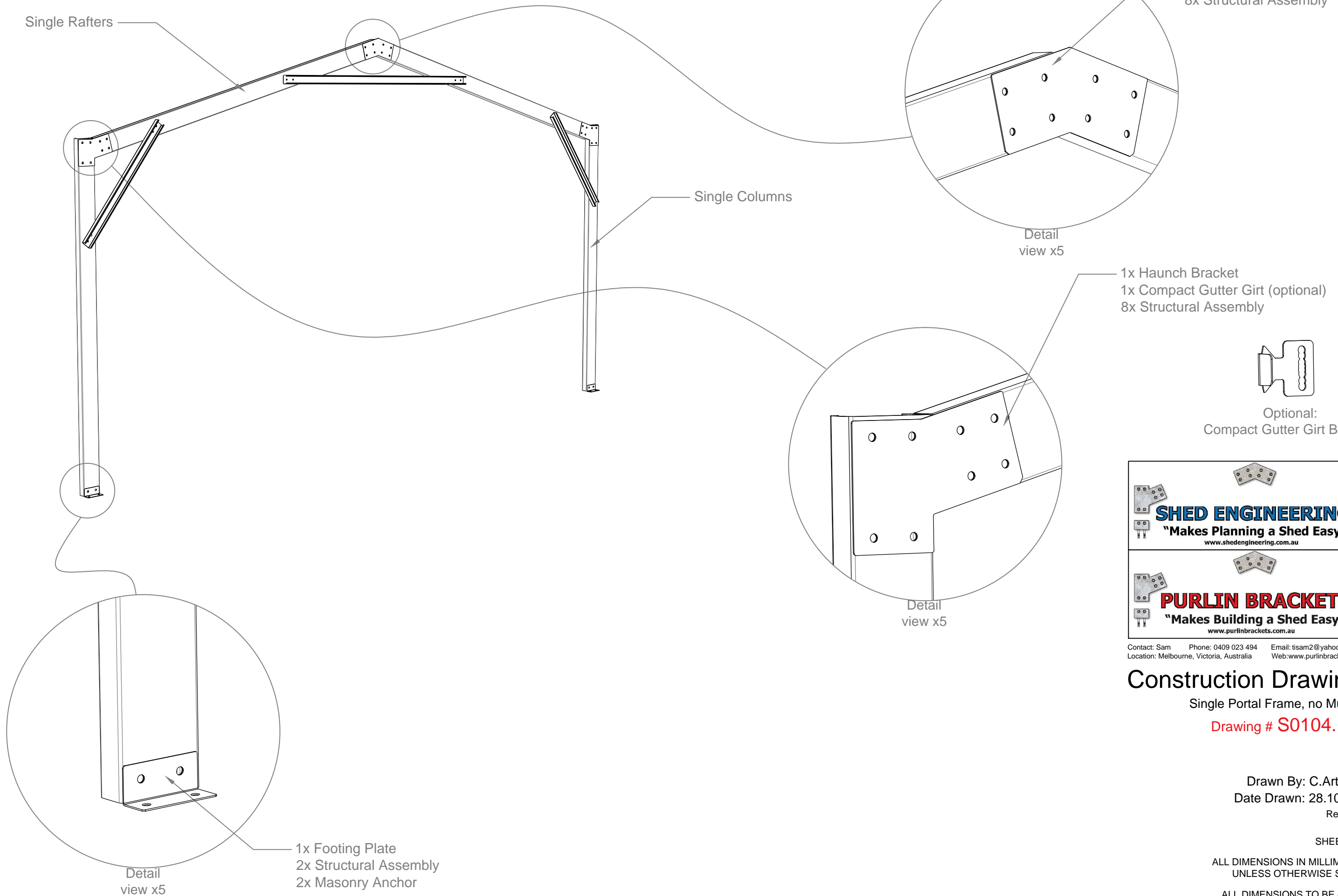

SHED ENGINEERING
"Makes Planning a Shed Easy"
www.shedengineering.com.au

PURLIN BRACKETS
"Makes Building a Shed Easy"
www.purlinbrackets.com.au

Contact: Sam Phone: 0409 023 494 Email: tisam2@yahoo.com.au
Location: Melbourne, Victoria, Australia Web: www.purlinbrackets.com.au

Construction Drawings

Single Portal Frame, no Mullions

Drawing # **S0104.I002**

Drawn By: C.Artemiou

Date Drawn: 28.10.2015

Revision: 0

SHEET 1 of 1

ALL DIMENSIONS IN MILLIMETERS
UNLESS OTHERWISE STATED

ALL DIMENSIONS TO BE +/- 1mm
UNLESS OTHERWISE STATED

Back to back end wall portal frames - 4m & 5m spacings

****ONLY 200mm/8" C Section can be used for back to back portal frames**

© Copyright, Purlin Brackets 2016

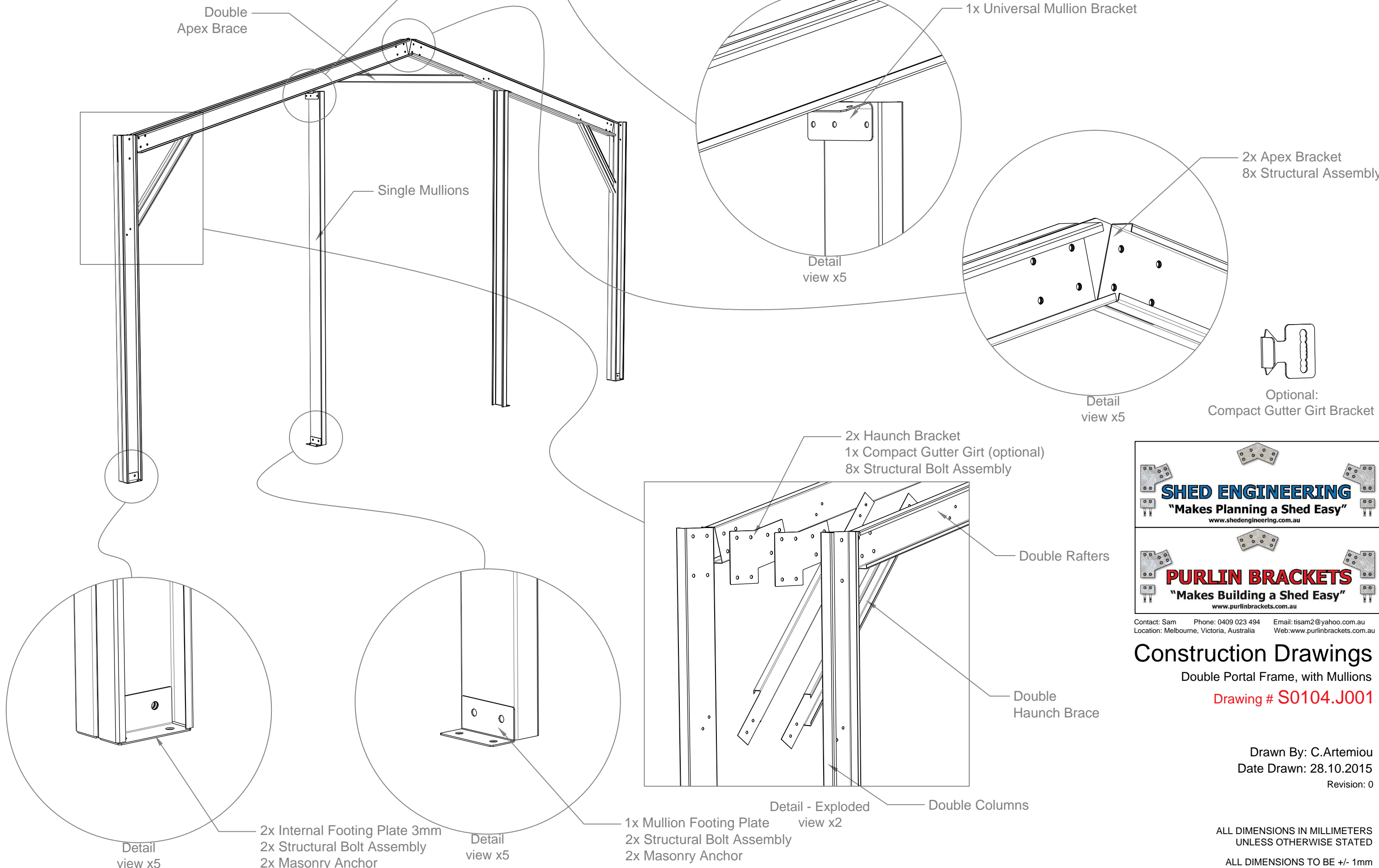



SHED ENGINEERING
 "Makes Planning a Shed Easy"
 www.shedengineering.com.au



PURLIN BRACKETS
 "Makes Building a Shed Easy"
 www.purlinbrackets.com.au

Contact: Sam Phone: 0409 023 494 Email: tisam2@yahoo.com.au
 Location: Melbourne, Victoria, Australia Web: www.purlinbrackets.com.au

Construction Drawings
 Double Portal Frame, with Mullions
 Drawing # **S0104.J001**

Drawn By: C.Artemiou
 Date Drawn: 28.10.2015
 Revision: 0

ALL DIMENSIONS IN MILLIMETERS
 UNLESS OTHERWISE STATED
 ALL DIMENSIONS TO BE +/- 1mm
 UNLESS OTHERWISE STATED

Back to back internal portal frames - 4m & 5m spacings

****ONLY 200mm/8" C Section can be used for back to back portal frames**

© Copyright, Purlin Brackets 2016

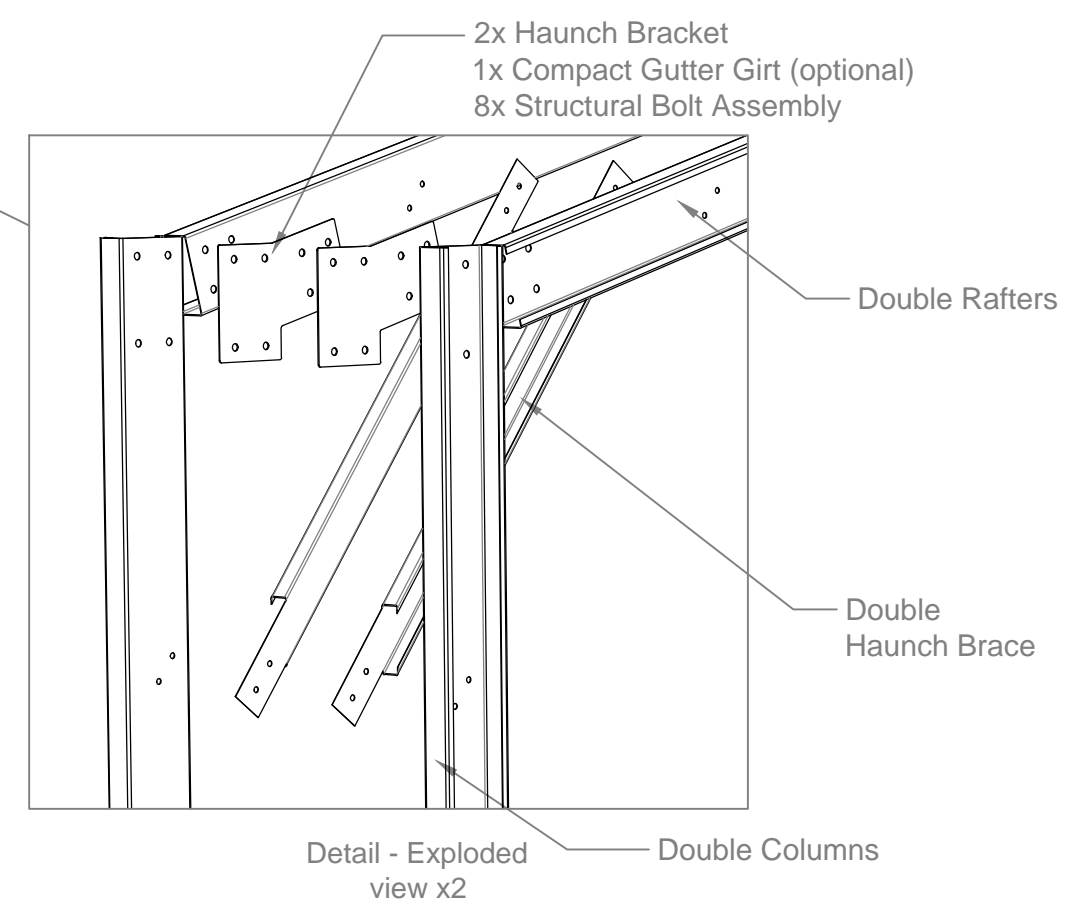
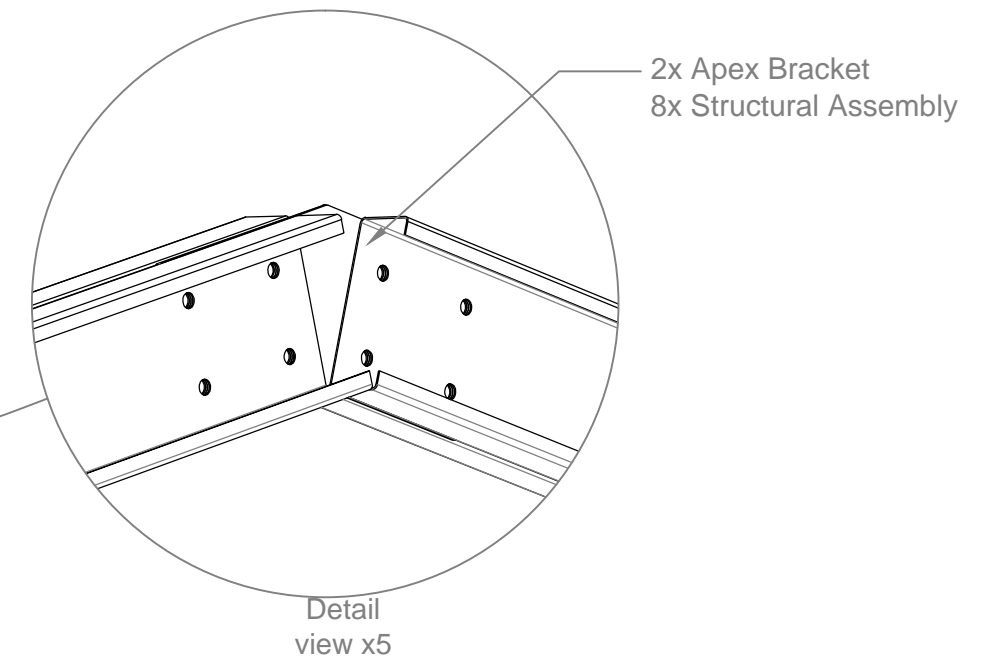
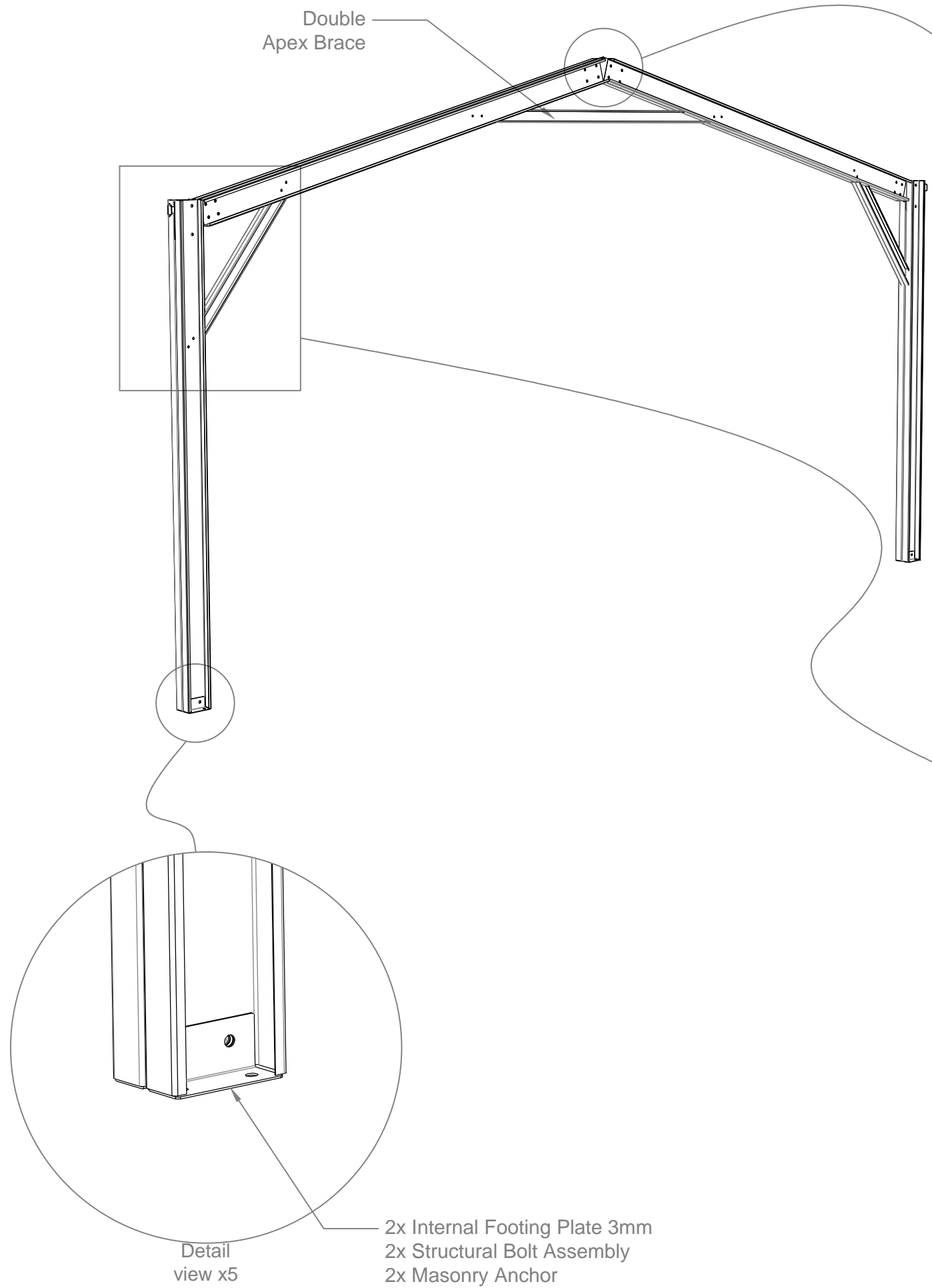



SHED ENGINEERING
 "Makes Planning a Shed Easy"
 www.shedengineering.com.au



PURLIN BRACKETS
 "Makes Building a Shed Easy"
 www.purlinbrackets.com.au

Contact: Sam Phone: 0409 023 494 Email: tsam2@yahoo.com.au
 Location: Melbourne, Victoria, Australia Web: www.purlinbrackets.com.au

Construction Drawings
 Double Portal Frame, no Mullions
Drawing # S0104.J002

Drawn By: C.Artemiou
 Date Drawn: 28.10.2015
 Revision: 0

ALL DIMENSIONS IN MILLIMETERS
 UNLESS OTHERWISE STATED
 ALL DIMENSIONS TO BE +/- 1mm
 UNLESS OTHERWISE STATED

Open Farm Shed & Industrial Shed -Roller Door Frame

NOTE: THIS IS A GENERIC SHED TO REPRESENT COMPONENTS

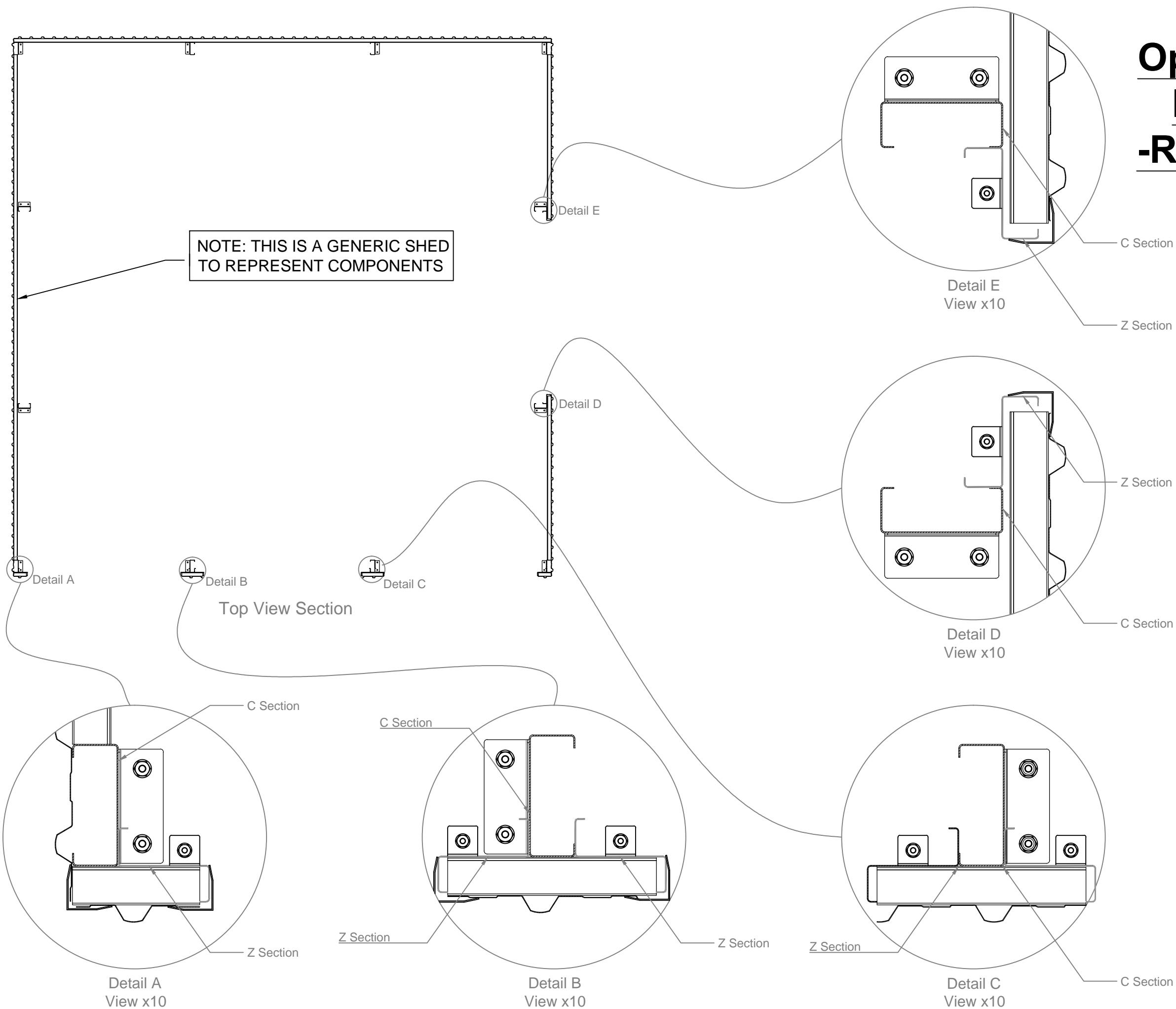

SHED ENGINEERING
"Makes Planning a Shed Easy"
www.shedengineering.com.au

PURLIN BRACKETS
"Makes Building a Shed Easy"
www.purlinbrackets.com.au

Contact: Sam Phone: 0409 023 494 Email: tsam2@yahoo.com.au
Location: Melbourne, Victoria, Australia Web: www.purlinbrackets.com.au

Construction Drawings
Open Farm Shed & Industrial Shed
Door Assembly detail
Drawing # **S0104.K001**

Drawn By: C.Artemiou
Date Drawn: 28.10.2015
Revision: 0

SHEET 1 of 1

ALL DIMENSIONS IN MILLIMETERS
UNLESS OTHERWISE STATED

ALL DIMENSIONS TO BE +/- 1mm
UNLESS OTHERWISE STATED

Customised Portal Frame Layout

Once you have purchased a shed set you will be supplied the following customised information.

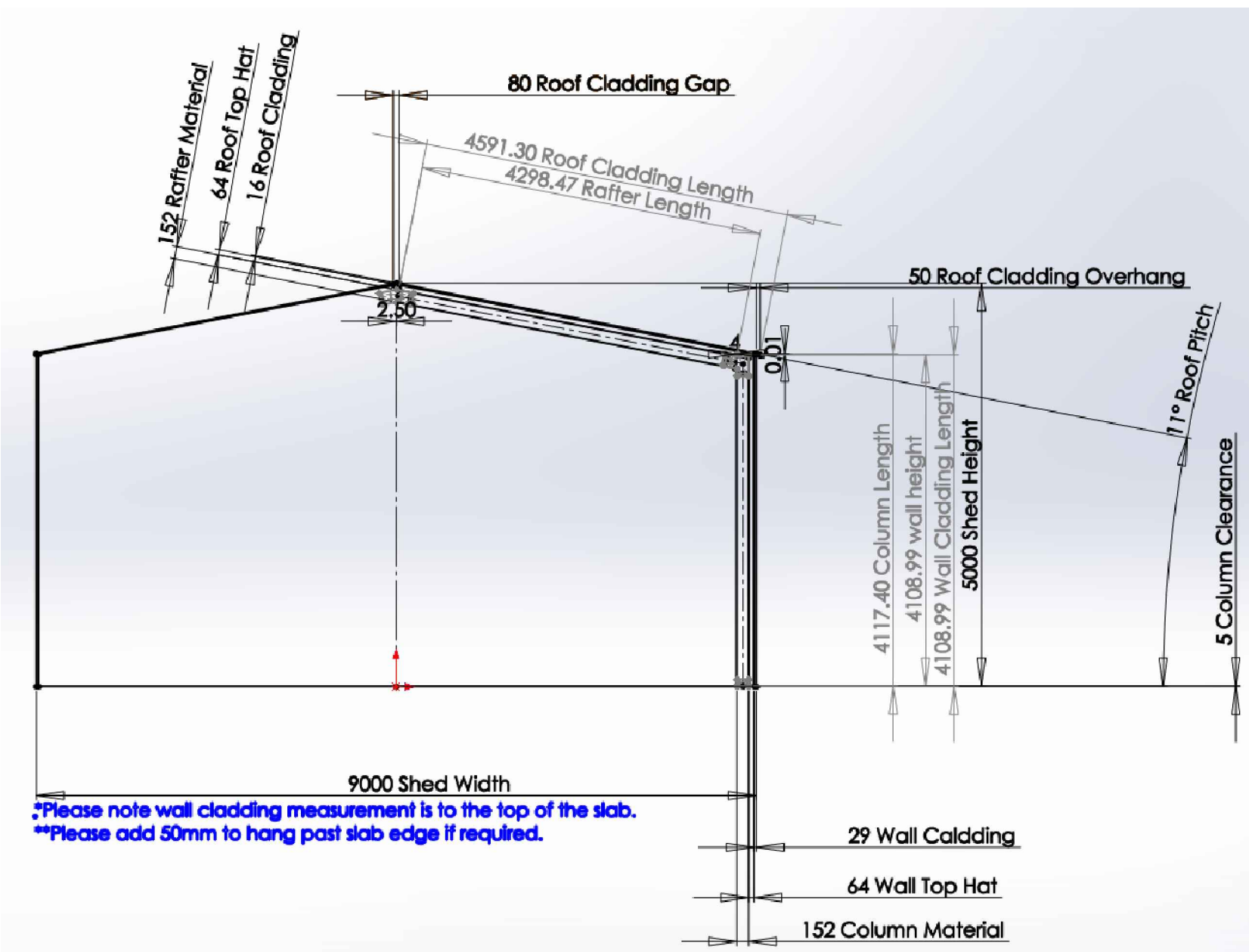

Portal Frame Dimensions



Contact: Sam Phone: 0409 023 494 Email: tisam2@yahoo.com.au
Location: Melbourne, Victoria, Australia Web: www.purlinbrackets.com.au
**all dimensions in mm

Punching Profile

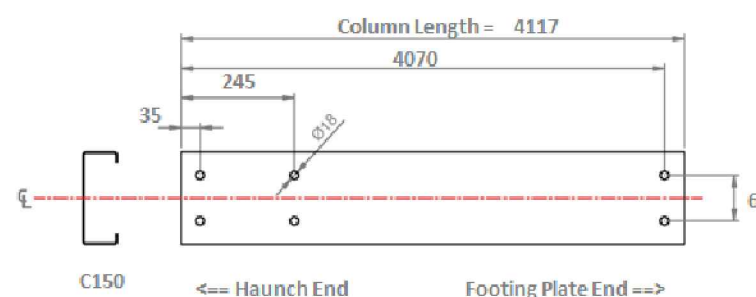
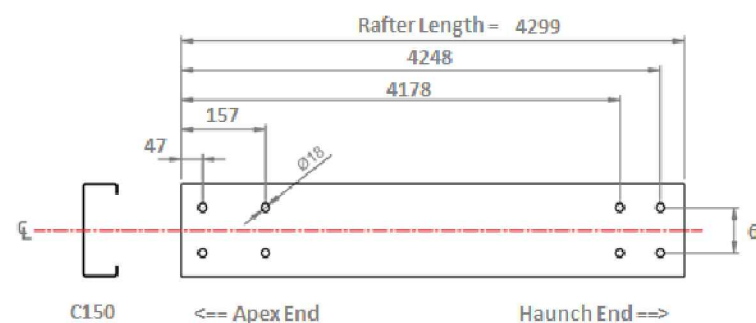

Item	Material	Length mm	Qty	Total Metres
Rafter	C150	4299	10	42.99
Column	C150	4117	10	41.17

Punching Profile

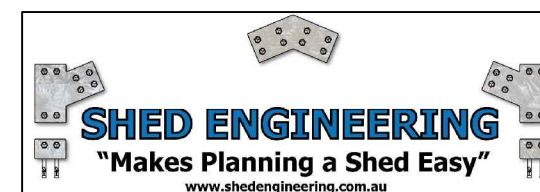

Contact: Sam Phone: 0409 023 494 Email: tisam2@yahoo.com.au
Location: Melbourne, Victoria, Australia Web: www.purlinbrackets.com.au

Construction Drawings

Customised Portal Frame Layout

Drawing # S0104.L001

Drawn By: C.Artemiou
Date Drawn: 28.10.2015
Revision: 0

SHEET 1 of 1

ALL DIMENSIONS IN MILLIMETERS
UNLESS OTHERWISE STATED

ALL DIMENSIONS TO BE +/- 1mm
UNLESS OTHERWISE STATED